

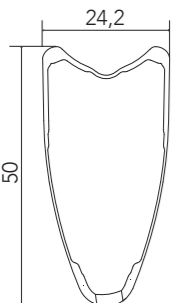

# BORA ULTRA 50

TUBULAR

# BORA ULTRA 50

TUBULAR

RIM		
	FRONT RIM	WH-101BO50 (bright) / WH-101BO50DK (dark)
	REAR RIM	WH-102BO50 (bright) / WH-102BO50DK (dark)
	VALVE HOLE	6,5 mm
	VALVE HOLE BUSHING	WH-BUU002 (5 pcs.) 
	VALVE EXTENSION	UT-HU150
	DIAMETER	634 mm
	BRAKE PADS	for carbon rims - BR-BO500 (for brakes with retention spring or interference fixing) - BR-BO500X1 (for brakes with screw fixing)

SPOKES		
FRONT / REAR LH SPOKE	WH-016BOT50	4 spokes + 4 nipples
REAR RH SPOKE	WH-019BOT50	4 spokes + 4 nipples
NIPPLES	WH-015BO80	black - 10 pieces
NIPPLE INSERT	UT-WH160	magnet-attractor for nipple
NIPPLE MAGNET	UT-WH050	nipple-guide
SPOKE SPANNER	UT-WH090	spoke wrenches

ACCESSORIES		
Spacer for HG11 FW body	FH-BUU001	5 pcs - to be used only with 9/10s sprockets (HG11 FW body package contains the spacer)

## ! WARNING!

Because of the high temperatures reached when breaking, we recommend you use only glue for tubular tires specifically for carbon fibre rims.  
A causa delle alte temperature raggiunte in frenata, vi consigliamo di utilizzare solamente colla per tubolari che sia specifica per i soli cerchi in fibra di carbonio.

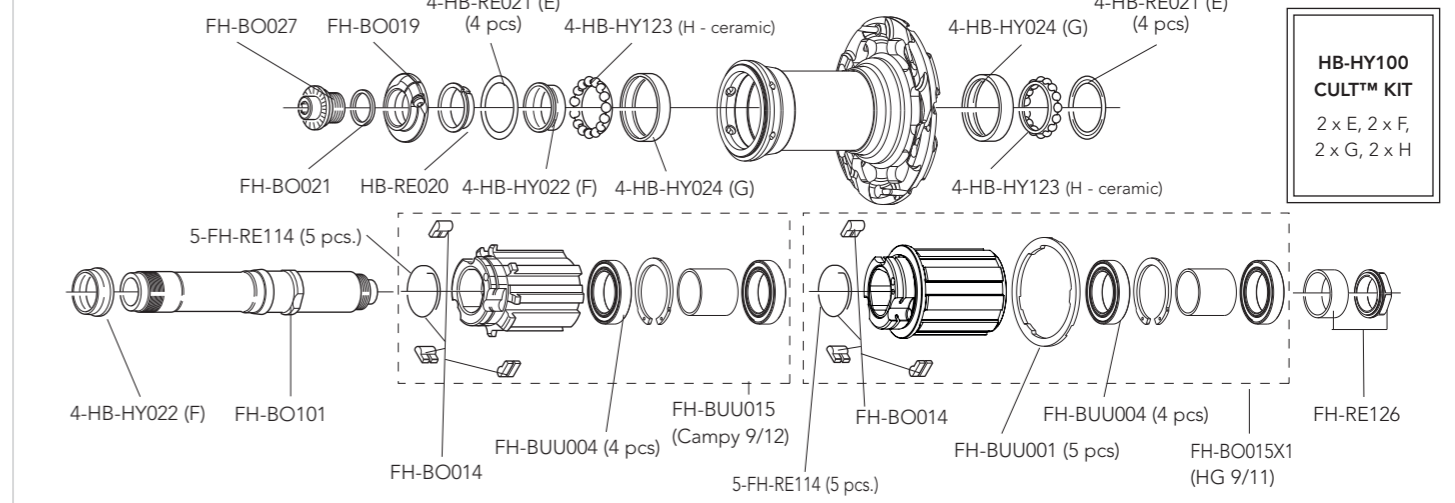
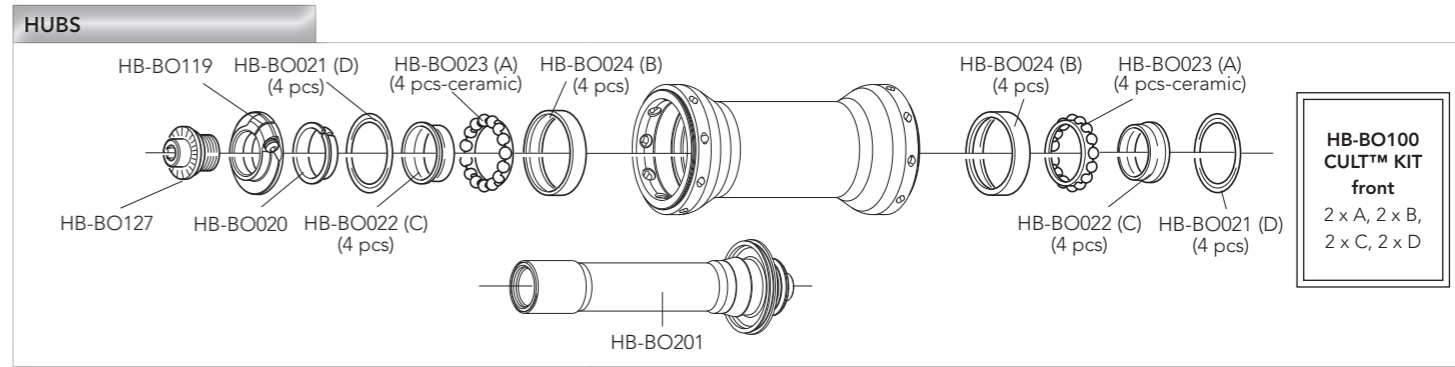

QUICK-RELEASES	QR12-BUUBFR	front + rear
----------------	-------------	--------------

WHEELS

WHEELS

# BORA ULTRA 35

TUBULAR

## RIM

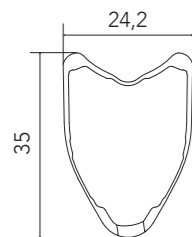

FRONT RIM	WH-201BO35 (bright) - WH-201BO35DK (dark)
REAR RIM	WH-202BO35 (bright) - WH-202BO35DK (dark)
VALVE HOLE	6,5 mm
VALVE HOLE BUSHING	WH-BUU002 (5 pcs.) 
DIAMETER	634 mm
BRAKE PADS	for carbon rims - BR-BO500 (for brakes with retention spring or interference fixing) - BR-BO500X1 (for brakes with screw fixing)

## SPOKES

FRONT / REAR LH SPOKE	WH-020BOC35	4 spokes + 4 nipples
REAR RH SPOKE	WH-021BOC35	4 spokes + 4 nipples
NIPPLES	WH-015BO80	black - 10 pieces
NIPPLE INSERT	UT-WH160	magnet-attractor for nipple
NIPPLE MAGNET	UT-WH050	nipple-guide
SPOKE SPANNER	UT-WH090	spoke wrenches

## ACCESSORIES

Spacer for HG11 FW body	FH-BUU001	5 pcs - to be used only with 9/10s sprockets (HG11 FW body package contains the spacer)
-------------------------	-----------	---

## ! WARNING!

Because of the high temperatures reached when braking, we recommend you use only glue for tubular tires specifically for carbon fibre rims.  
A causa delle alte temperature raggiunte in frenata, vi consigliamo di utilizzare solamente colla per tubolari che sia specifica per i soli cerchi in fibra di carbonio.

# BORA ULTRA 35

TUBULAR

## HUBS

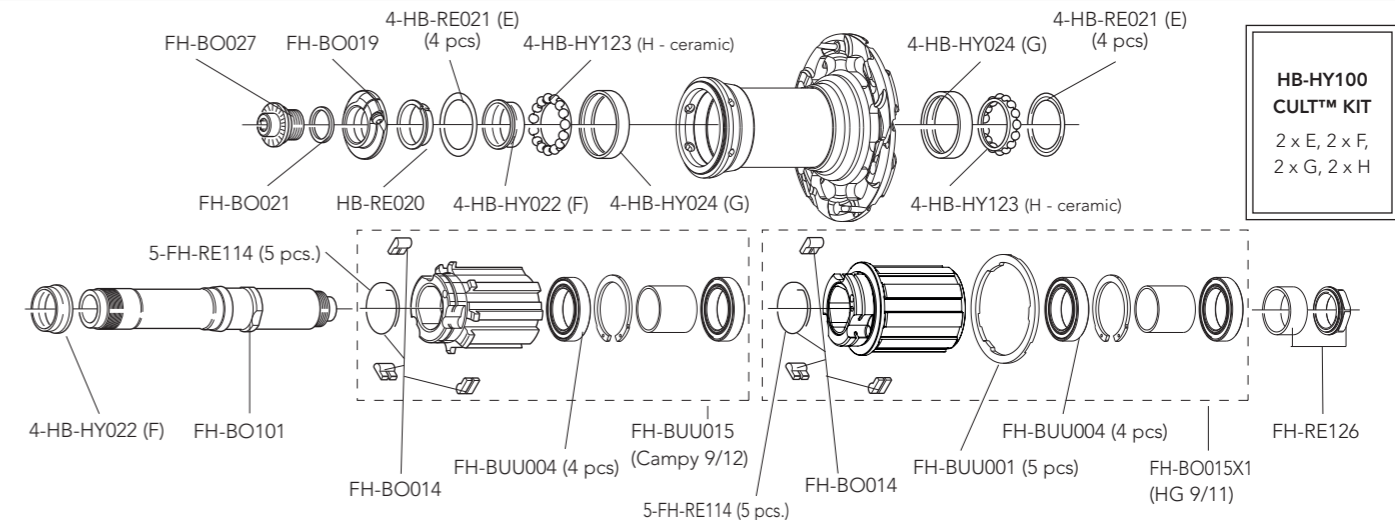
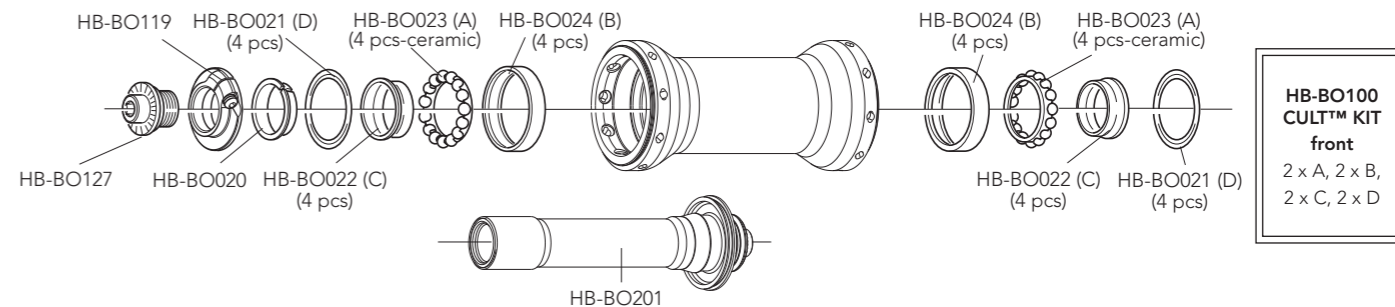

QUICK-RELEASES	QR12-BUUBFR	front + rear
----------------	-------------	--------------

# BORA ULTRA 50

CLINCHER

# BORA ULTRA 50

CLINCHER

## RIM

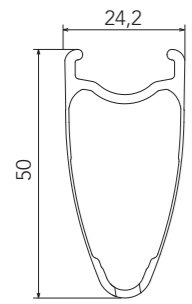

FRONT RIM	WH-103BO50 (bright) / WH-103BO50DK (dark)
REAR RIM	WH-104BO50 (bright) / WH-104BO50DK (dark)
VALVE HOLE	6,5 mm
VALVE HOLE BUSHING	WH-BUU002 (5 pcs.)
VALVE EXTENSION	UT-HU150
DIAMETER	700C (622 x 17C)
BRAKE PADS	for carbon rims - BR-BO500 (for brakes with retention spring or interference fixing) - BR-BO500X1 (for brakes with screw fixing)

## SPOKES

FRONT / REAR LH SPOKE	WH-016BOT50	4 spokes + 4 nipples
REAR RH SPOKE	WH-019BOT50	4 spokes + 4 nipples
NIPPLES	WH-015BO80	black - 10 pieces
NIPPLE INSERT	UT-WH160	magnet-attractor for nipple
NIPPLE MAGNET	UT-WH050	nipple-guide
SPOKE SPANNER	UT-WH090	spoke wrenches

## ACCESSORIES

Spacer for HG11 FW body	FH-BUU001	5 pcs - to be used only with 9/10s sprockets (HG11 FW body package contains the spacer)
-------------------------	-----------	--

## HUBS

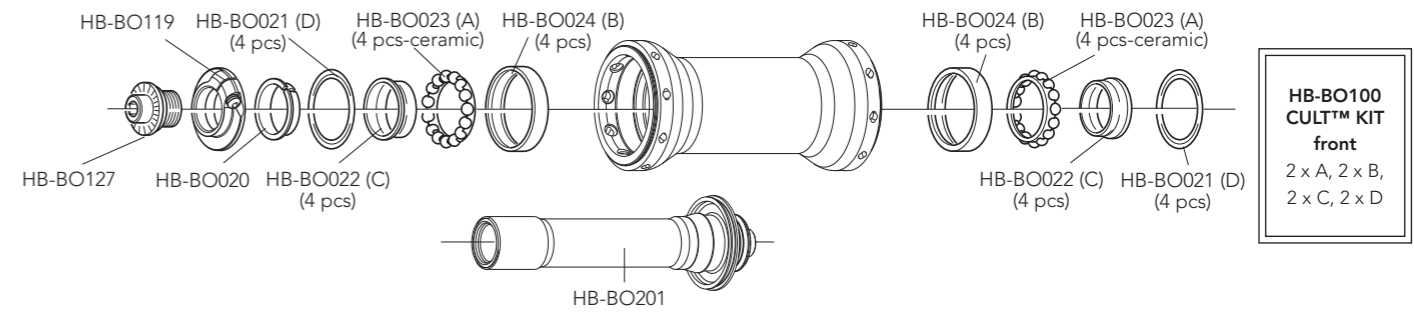

**HB-BO100  
CULT™ KIT  
front**  
2 x A, 2 x B,  
2 x C, 2 x D

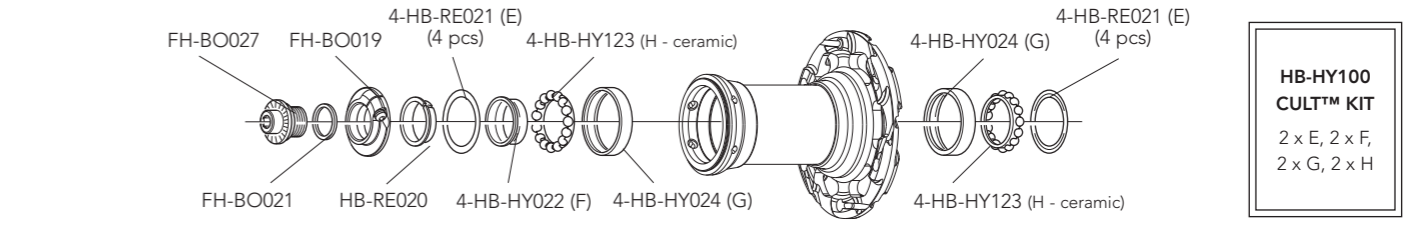

**HB-HY100  
CULT™ KIT**  
2 x E, 2 x F,  
2 x G, 2 x H

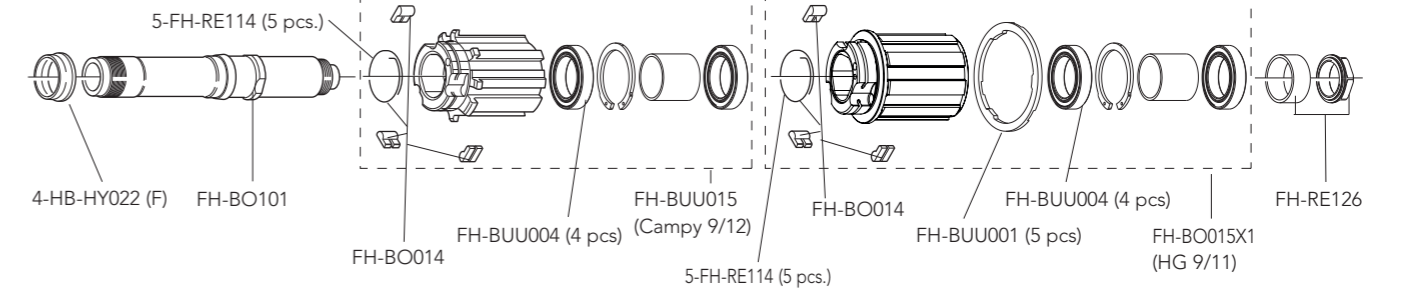



QUICK-RELEASES	QR12-BUUBFR	front + rear
----------------	-------------	--------------

WHEELS

WHEELS

# BORA ULTRA 35

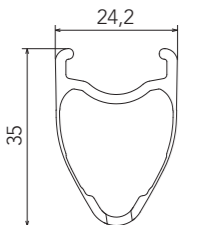
CLINCHER

RIM		
	FRONT RIM	WH-103BO35 (bright) - WH-103BO35DK (dark)
	REAR RIM	WH-104BO35 (bright) - WH-104BO35DK (dark)
	VALVE HOLE	6,5 mm
	VALVE HOLE BUSHING	WH-BUU002 (5 pcs.) 
	DIAMETER	700C (622 x 17C)
	BRAKE PADS	for carbon rims - BR-BO500 (for brakes with retention spring or interference fixing) - BR-BO500X1 (for brakes with screw fixing)

SPOKES		
FRONT / REAR LH SPOKE	WH-020BOC35	4 spokes + 4 nipples
REAR RH SPOKE	WH-021BOC35	4 spokes + 4 nipples
NIPPLES	WH-015BO80	black - 10 pieces
NIPPLE INSERT	UT-WH160	magnet-attractor for nipple
NIPPLE MAGNET	UT-WH050	nipple-guide
SPOKE SPANNER	UT-WH090	spoke wrenches

ACCESSORIES		
Spacer for HG11 FW body	FH-BUU001	5 pcs - to be used only with 9/10s sprockets (HG11 FW body package contains the spacer)

# BORA ULTRA 35

CLINCHER

**HUBS**

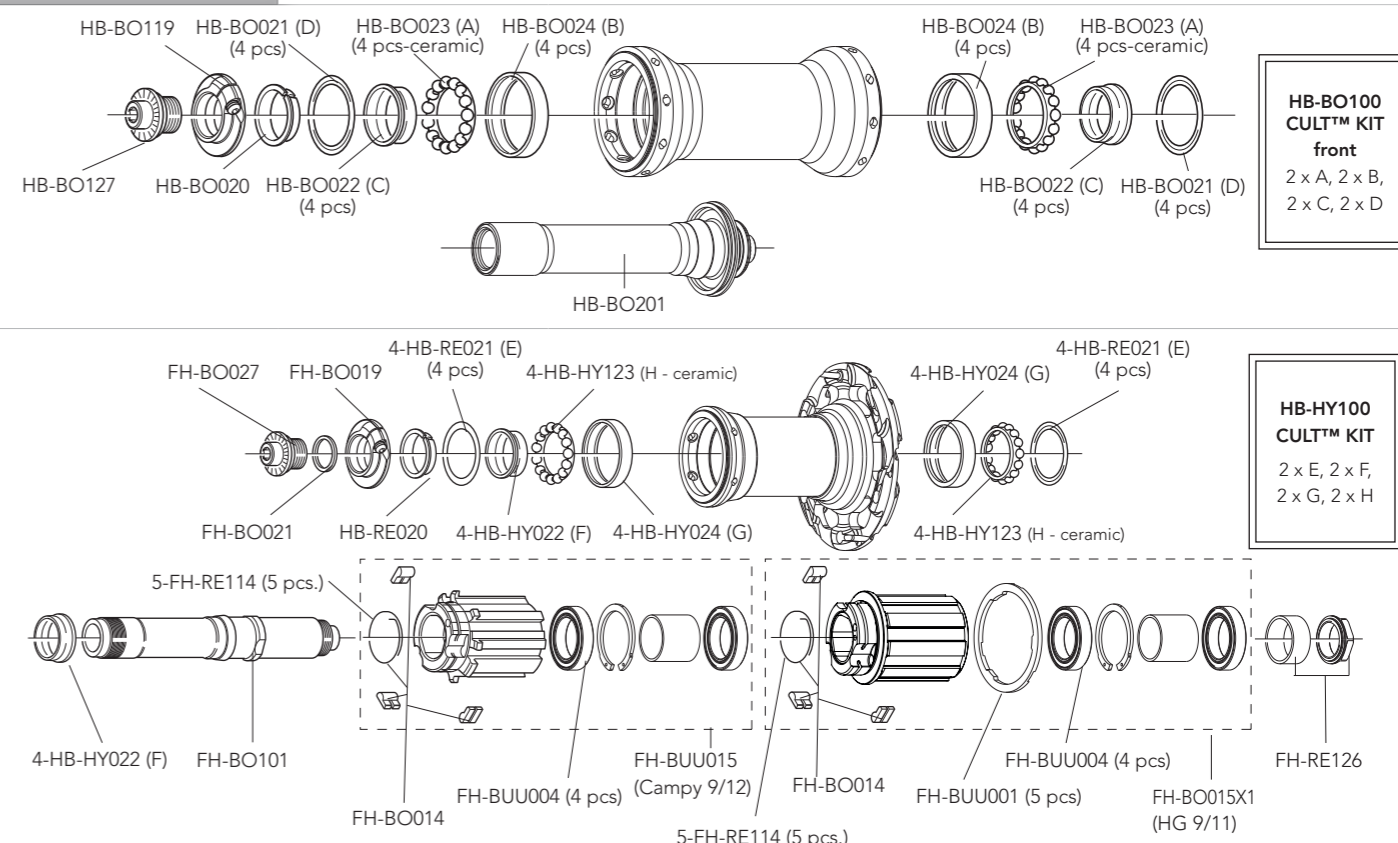



**HB-BO100 CULT™ KIT front**  
2 x A, 2 x B, 2 x C, 2 x D

**HB-HY100 CULT™ KIT**  
2 x E, 2 x F, 2 x G, 2 x H

**QUICK-RELEASES**      QR12-BUUBFR      front + rear

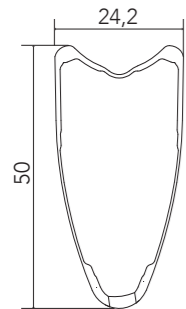
## RIM



VALVE HOLE	6,5 mm
VALVE EXTENSION	UT-HU150
VALVE HOLE BUSHING	WH-BUU002 
DIAMETER	634 mm
BRAKE PADS	for carbon rims - BR-BO500 (for brakes with retention spring or interference fixing) - BR-BO500X1 (for brakes with screw fixing)

## SPOKES

FRONT / REAR LH SPOKE	WH-016BOT50	4 spokes + 4 nipples
REAR RH SPOKE	WH-019BOT50	4 spokes + 4 nipples
NIPPLES	WH-015BO80	black - 10 pieces
NIPPLE INSERT	UT-WH160	magnet-attractor for nipple
NIPPLE MAGNET	UT-WH050	nipple-guide
SPOKE SPANNER	UT-WH090	spoke wrenches

## ACCESSORIES

Spacer for HG11 FW body	FH-BUU001	5 pcs - to be used only with 9/10s sprockets (HG11 FW body package contains the spacer)
-------------------------	-----------	---

### WARNING!

Because of the high temperatures reached when braking, we recommend you use only glue for tubular tires specifically for carbon fibre rims.  
 A causa delle alte temperature raggiunte in frenata, vi consigliamo di utilizzare solamente colla per tubolari che sia specifica per i soli cerchi in fibra di carbonio.

## HUBS

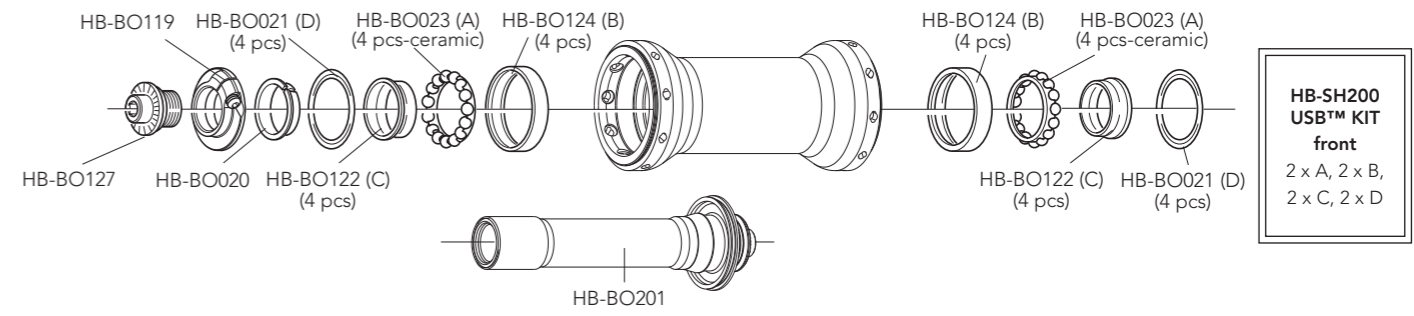

**HB-SH200 USB™ KIT front**  
 2 x A, 2 x B, 2 x C, 2 x D

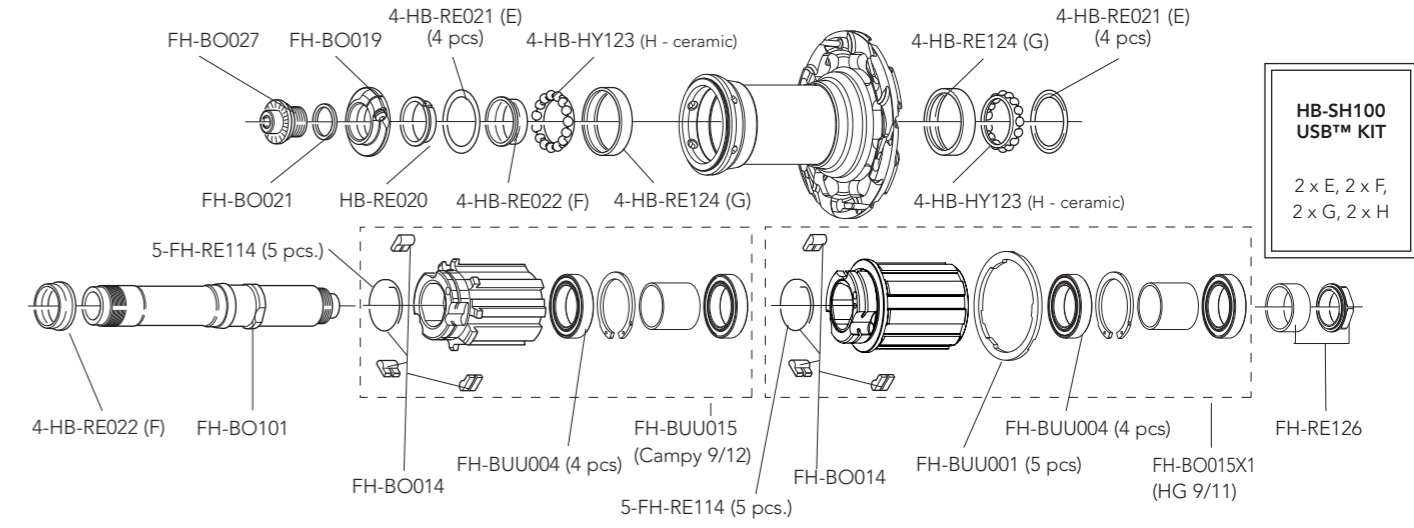

**HB-SH100 USB™ KIT**  
 2 x E, 2 x F, 2 x G, 2 x H

QUICK-RELEASES	QR12-BUUBFR	front + rear
----------------	-------------	--------------

RIM		
	VALVE HOLE	6,5 mm
	VALVE HOLE BUSHING	WH-BUU002
	DIAMETER	634 mm
	BRAKE PADS	for carbon rims - BR-BO500 (for brakes with retention spring or interference fixing) - BR-BO500X1 (for brakes with screw fixing)

SPOKES		
FRONT / REAR LH SPOKE	WH-020BOC35	4 spokes + 4 nipples
REAR RH SPOKE	WH-021BOC35	4 spokes + 4 nipples
NIPPLES	WH-015BO80	black - 10 pieces
NIPPLE INSERT	UT-WH160	magnet-attractor for nipple
NIPPLE MAGNET	UT-WH050	nipple-guide
SPOKE SPANNER	UT-WH090	spoke wrenches

ACCESSORIES		
Spacer for HG11 FW body	FH-BUU001	5 pcs - to be used only with 9/10s sprockets (HG11 FW body package contains the spacer)

## ! WARNING!

Because of the high temperatures reached when braking, we recommend you use only glue for tubular tires specifically for carbon fibre rims.  
A causa delle alte temperature raggiunte in frenata, vi consigliamo di utilizzare solamente colla per tubolari che sia specifica per i soli cerchi in fibra di carbonio.

HUBS		
	<p><b>HB-SH200 USB™ KIT front</b> 2 x A, 2 x B, 2 x C, 2 x D</p>	
	<p><b>HB-SH100 USB™ KIT</b> 2 x E, 2 x F, 2 x G, 2 x H</p>	
QUICK-RELEASES	QR12-BUUBFR	front + rear

## RIM

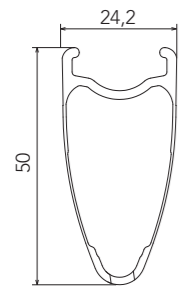

VALVE HOLE	6,5 mm
VALVE EXTENSION	UT-HU150
VALVE HOLE BUSHING	WH-BUU002 
DIAMETER	700C (622 x 17C)
BRAKE SHOES	for carbon rims - BR-BO500 (for brakes with retention spring or interference fixing) - BR-BO500X1 (for brakes with screw fixing)

## SPOKES

FRONT / REAR LH SPOKE	WH-016BOT50	4 spokes + 4 nipples
REAR RH SPOKE	WH-019BOT50	4 spokes + 4 nipples
NIPPLES	WH-015BO80	black - 10 pieces
NIPPLE INSERT	UT-WH160	magnet-attractor for nipple
NIPPLE MAGNET	UT-WH050	nipple-guide
SPOKE SPANNER	UT-WH090	spoke wrenches

## ACCESSORIES

Spacer for HG11 FW body	FH-BUU001	5 pcs - to be used only with 9/10s sprockets (HG11 FW body package contains the spacer)
-------------------------	-----------	---

## HUBS

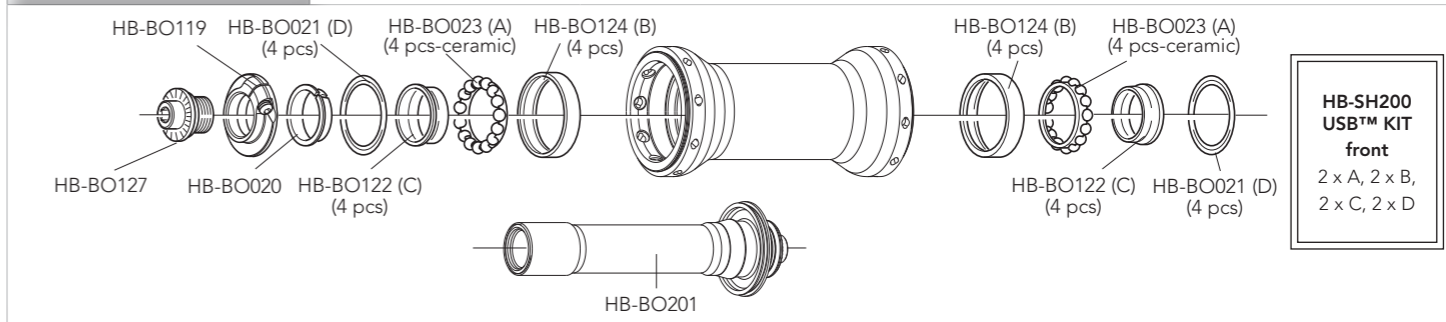

**HB-SH200 USB™ KIT front**  
2 x A, 2 x B, 2 x C, 2 x D

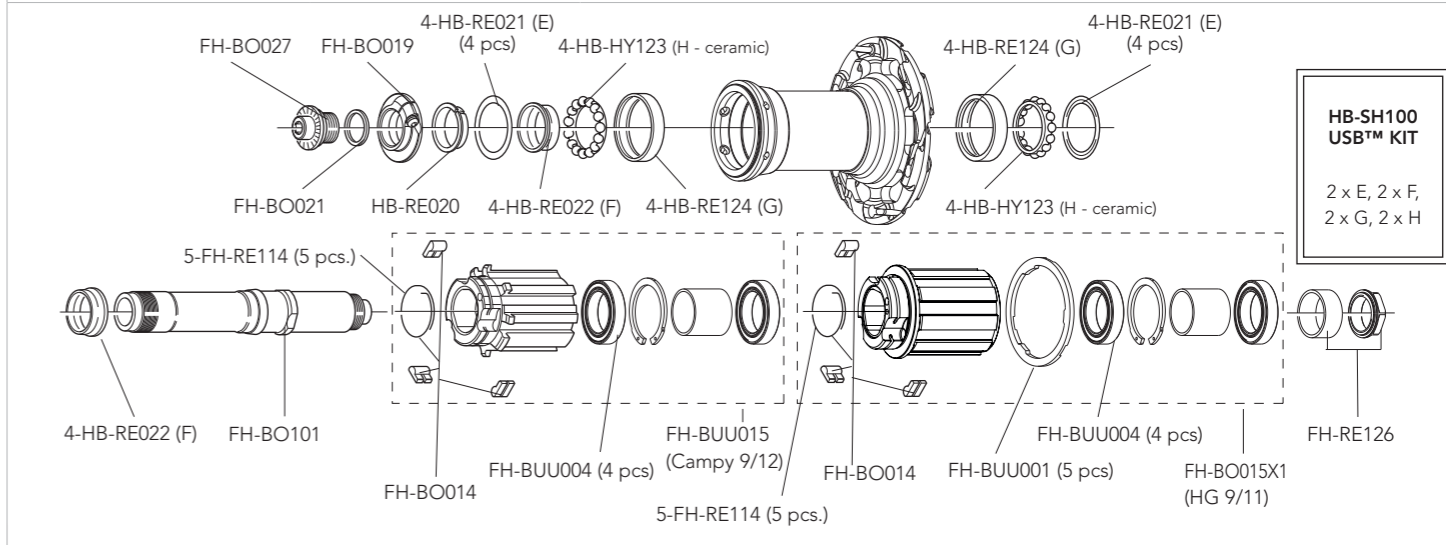

**HB-SH100 USB™ KIT**  
2 x E, 2 x F, 2 x G, 2 x H

QUICK-RELEASES	QR12-BUUBFR	front + rear
----------------	-------------	--------------

# BORA ONE 35

CLINCHER

# BORA ONE 35

CLINCHER

## RIM

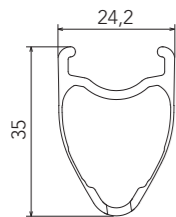

VALVE HOLE	6,5 mm
VALVE HOLE BUSHING	WH-BUU002 
DIAMETER	700C (622 x 17C)
BRAKE SHOES	for carbon rims - BR-BO500 (for brakes with retention spring or interference fixing) - BR-BO500X1 (for brakes with screw fixing)

## SPOKES

FRONT / REAR LH SPOKE	WH-020BOC35	4 spokes + 4 nipples
REAR RH SPOKE	WH-021BOC35	4 spokes + 4 nipples
NIPPLES	WH-015BO80	black - 10 pieces
NIPPLE INSERT	UT-WH160	magnet-attractor for nipple
NIPPLE MAGNET	UT-WH050	nipple-guide
SPOKE SPANNER	UT-WH090	spoke wrenches

## ACCESSORIES

Spacer for HG11 FW body	FH-BUU001	5 pcs - to be used only with 9/10s sprockets (HG11 FW body package contains the spacer)
-------------------------	-----------	--

## HUBS

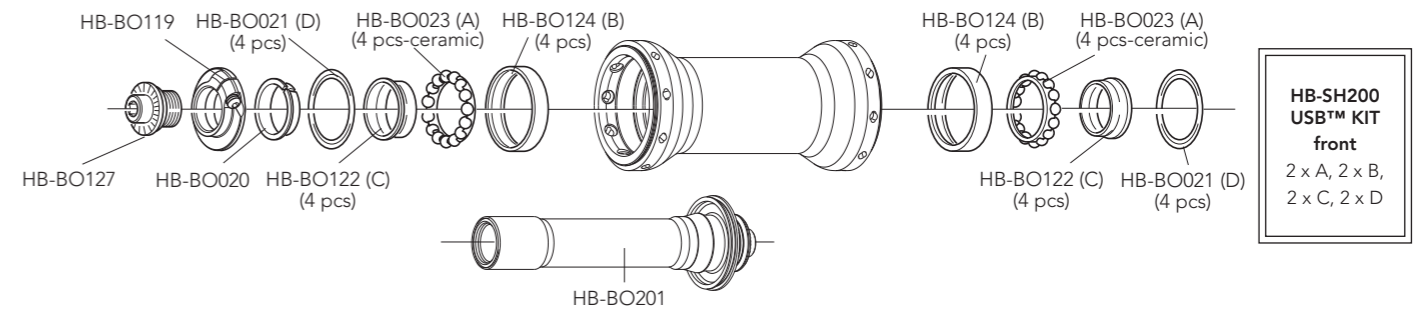

**HB-SH200  
USB™ KIT  
front**  
2 x A, 2 x B,  
2 x C, 2 x D

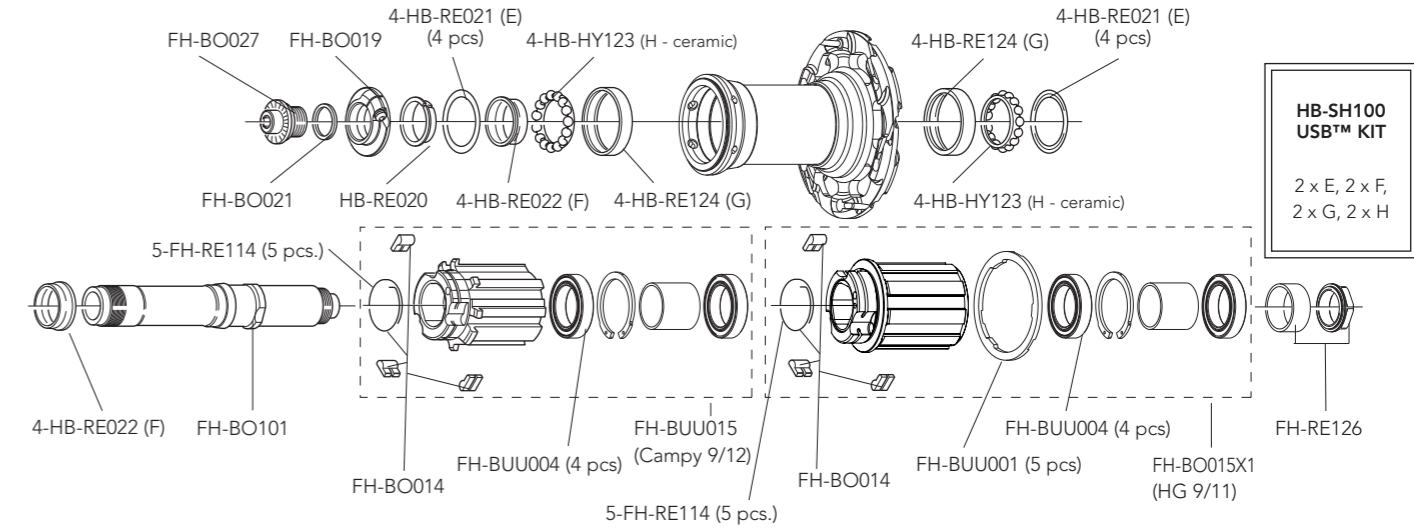



**HB-SH100  
USB™ KIT**  
2 x E, 2 x F,  
2 x G, 2 x H

QUICK-RELEASES	QR12-BUUBFR	front + rear
----------------	-------------	--------------

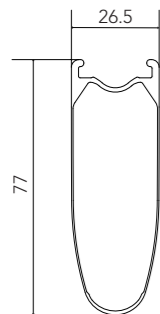

## RIM



VALVE HOLE	6,5 mm
VALVE EXTENSION	UT-WH140M (male extension)
2-WAY FIT™ VALVE	WH-SH101
VALVE HOLE BUSHING	WH-BUU002 (5 pcs.) 
DIAMETER	700C (622 x 19C)
BRAKE PADS	for carbon rims - BR-BO500 (for brakes with retention spring or interference fixing) - BR-BO500X1 (for brakes with screw fixing)

## SPOKES

COMPLETE FRONT SPOKES	<a href="#">WH-01BWTO77</a>	4 spokes + 4 nipples
NIPPLES	WH-015BO80	black - 10 pieces
NIPPLE INSERT	UT-WH160	magnet-attractor for nipple
NIPPLE MAGNET	UT-WH050	nipple-guide
SPOKE SPANNER	UT-WH090	spoke wrenches

## HUBS

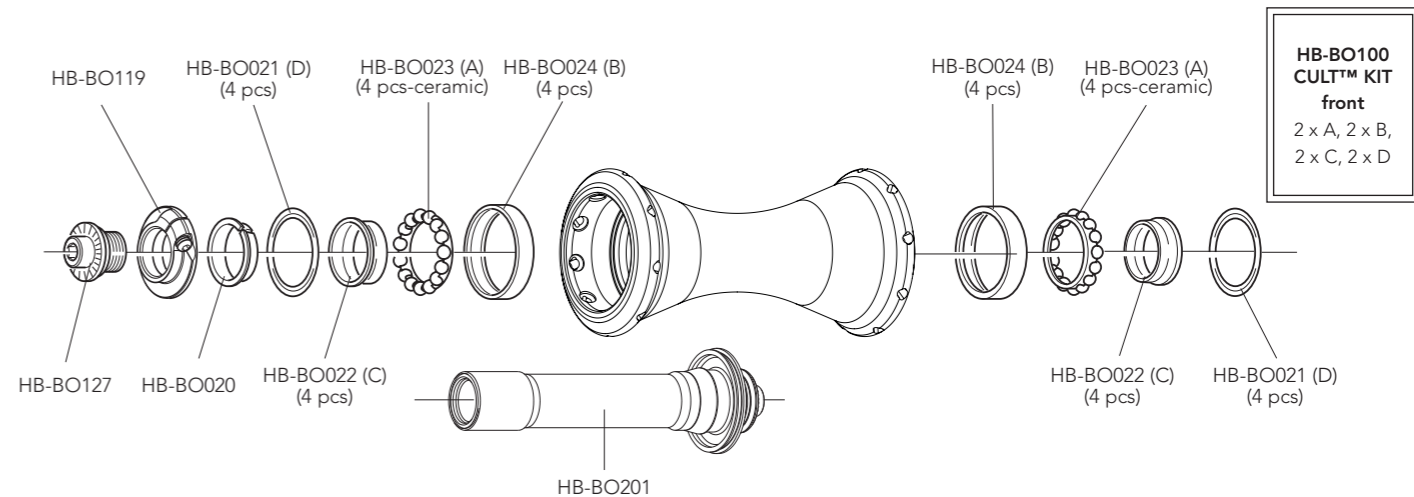

QUICK-RELEASES	QR12-BUUBFR	front + rear
----------------	-------------	--------------

## RIM

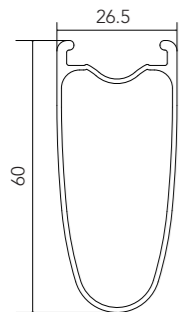

FRONT RIM	WH-03BWTO60 (bright) - WH-05BWTO60 (dark)
REAR RIM	WH-04BWTO60 (bright) - WH-06BWTO60 (dark)
VALVE EXTENSION	UT-WH140M (male extension)
2-WAY FIT™ VALVE	VA-2WF44
VALVE HOLE	6,5 mm
VALVE HOLE BUSHING	WH-BUU002 (5 pcs.) 
DIAMETER	700C (622 x 19C)
BRAKE PADS	for carbon rims - BR-BO500 (for brakes with retention spring or interference fixing) - BR-BO500X1 (for brakes with screw fixing)

## SPOKES

FRONT / REAR LH	WH-01BWTO60	4 spokes + 4 nipples
REAR RH	WH-02BWTO60	4 spokes + 4 nipples
NIPPLES	WH-015B080	black - 10 pieces
NIPPLE INSERT	UT-WH160	magnet-attractor for nipple
NIPPLE MAGNET	UT-WH050	nipple-guide
SPOKE SPANNER	UT-WH090	spoke wrenches

## ACCESSORIES

Spacer for HG11 FW body	FH-BUU001	5 pcs - to be used only with 9/10s sprockets (HG11 FW body package contains the spacer)
-------------------------	-----------	---

## HUBS

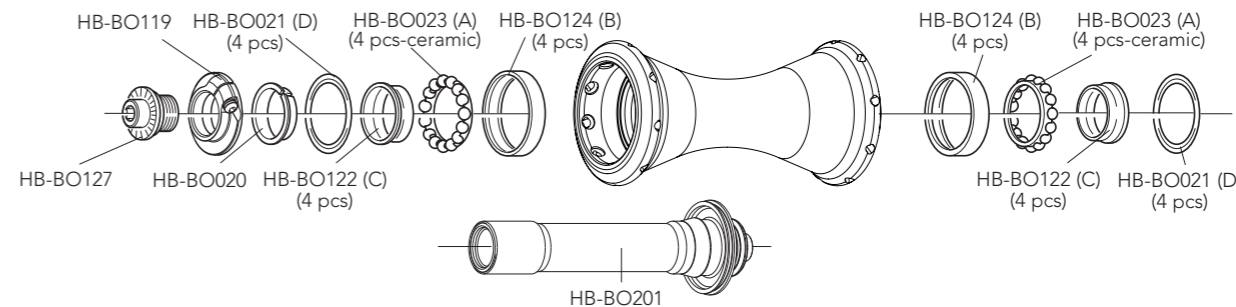

**HB-SH200  
USB™ KIT  
front**  
2 x A, 2 x B,  
2 x C, 2 x D

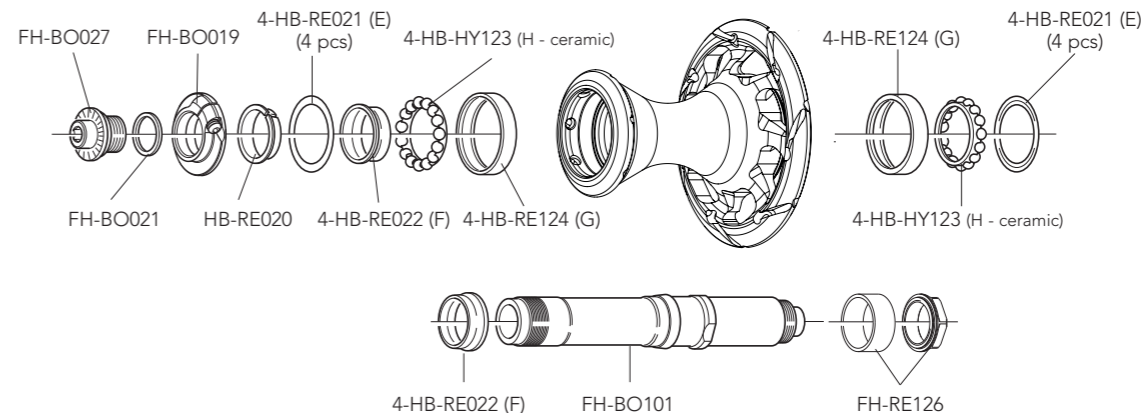

**HB-SH100  
USB™ KIT**  
2 x E, 2 x F,  
2 x G, 2 x H

QUICK-RELEASES

QR12-BUUBFR

front + rear

Complete FW body / Corpetti RL completi **FH-BUU015** (Campagnolo 9/12) - **FH-BO015X1** (HG 9/11) - **FH-BU016XDR** (XDR) See exploded view pag. 138

## RIM

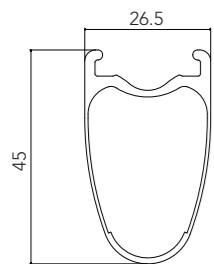

FRONT RIM	<a href="#">WH-03BWTO45</a> (bright) - <a href="#">WH-05BWTO45</a> (dark)
REAR RIM	<a href="#">WH-04BWTO45</a> (bright) - <a href="#">WH-06BWTO45</a> (dark)
VALVE EXTENSION	UT-WH130M (male extension)
2-WAY FIT™ VALVE	WH-SH101
VALVE HOLE	6,5 mm
VALVE HOLE BUSHING	WH-BUU002 (5 pcs.) 
DIAMETER	<a href="#">700C (622 x 19C)</a>
BRAKE PADS	for carbon rims - BR-BO500 (for brakes with retention spring or interference fixing) - BR-BO500X1 (for brakes with screw fixing)

## SPOKES

FRONT / REAR LH	<a href="#">WH-01BWTO45</a>	4 spokes + 4 nipples
REAR RH	<a href="#">WH-02BWTO45</a>	4 spokes + 4 nipples
NIPPLES	WH-015B080	black - 10 pieces
NIPPLE INSERT	UT-WH160	magnet-attractor for nipple
NIPPLE MAGNET	UT-WH050	nipple-guide
SPOKE SPANNER	UT-WH090	spoke wrenches

## ACCESSORIES

Spacer for HG11 FW body	FH-BUU001	5 pcs - to be used only with 9/10s sprockets (HG11 FW body package contains the spacer)
-------------------------	-----------	--

## HUBS

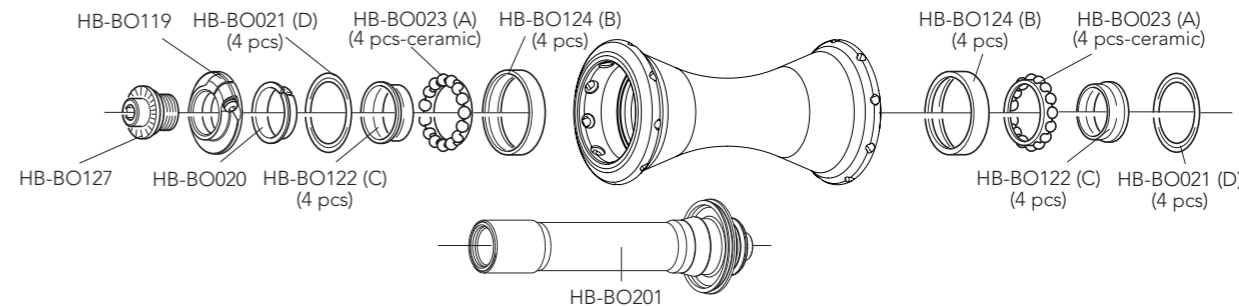

**HB-SH200  
USB™ KIT  
front**  
2 x A, 2 x B,  
2 x C, 2 x D

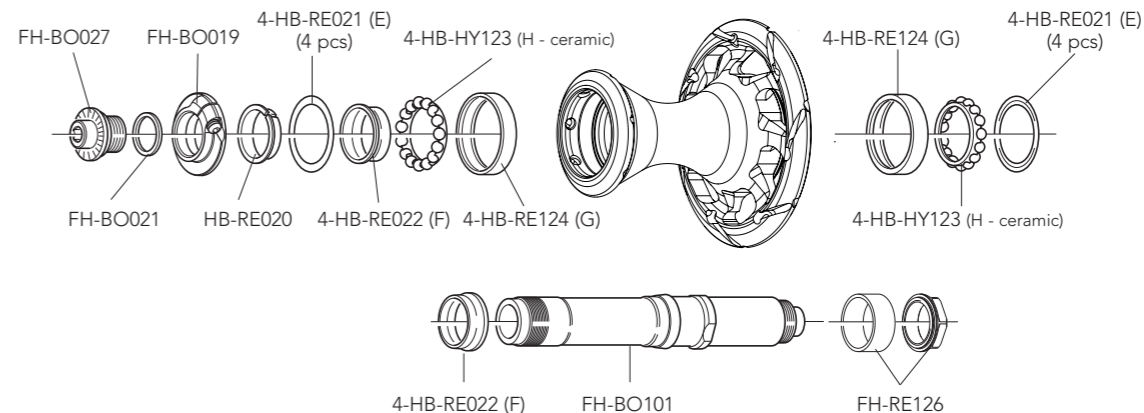

**HB-SH100  
USB™ KIT**  
2 x E, 2 x F,  
2 x G, 2 x H

QUICK-RELEASES

QR12-BUUBFR

front + rear

Complete FW body / Corpetti RL completi **FH-BUU015** (Campagnolo 9/12) - **FH-BO015X1** (HG 9/11) - **FH-BU016XDR** (XDR) See exploded view pag. 138

# SHAMAL MILLE

CLINCHER

# SHAMAL MILLE

CLINCHER

## RIM

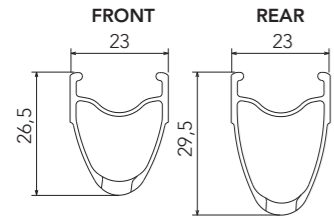

FRONT RIM  
REAR RIM  
LABEL KIT  
VALVE HOLE  
DIAMETER  
BRAKE PADS

WH-103SHM (no labels)  
WH-104SHM (no labels)  
LAB-SHMC17 (front+rear)  
6,5 mm  
622 X 17C  
for rims with Plasma Electrolytic Oxydation treatment: BR-PEO5001 (for brakes with retention spring fixing) - BR-PEO500X1 (for brakes with screw fixing)

## SPOKES

FRONT KIT	KIT-23SHB	16 front spokes
REAR KIT	KIT-34SHB	14 front/rear right spokes + 7 rear left spokes
COMPLETE FRONT SPOKE	WH-105SHM	spoke + nipple
COMPLETE REAR RIGHT SPOKE	WH-008SHM	spoke + nipple
COMPLETE REAR LEFT SPOKE	WH-007SHM	spoke + nipple
NIPPLES	WH-015SHM	10 pieces
SPOKE RING	UT-WH010	anti-rotation spokes
NIPPLE INSERT	UT-WH020	magnet-attractor for nipple
NIPPLE MAGNET	UT-WH050	nipple-guide
SPOKE SPANNER	UT-WH270	spoke wrench <b>(SERVICE CENTER Only)</b>

## ACCESSORIES

Spacer for HG11 FW body	FH-BUU001	5 pcs - to be used only with 9/10s sprockets (HG11 FW body package contains the spacer)
-------------------------	-----------	--

## HUBS

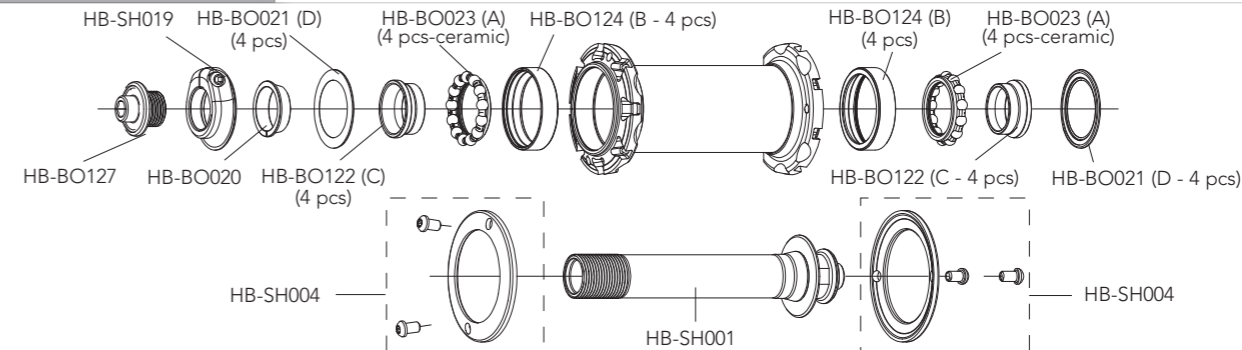

**HB-SH200  
USB™ KIT  
front**  
2 x A, 2 x B,  
2 x C, 2 x D

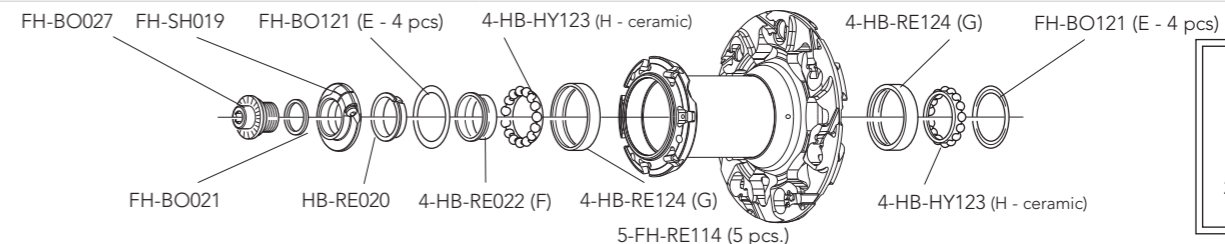

**HB-SH100  
USB™ KIT**  
2 x E, 2 x F,  
2 x G, 2 x H

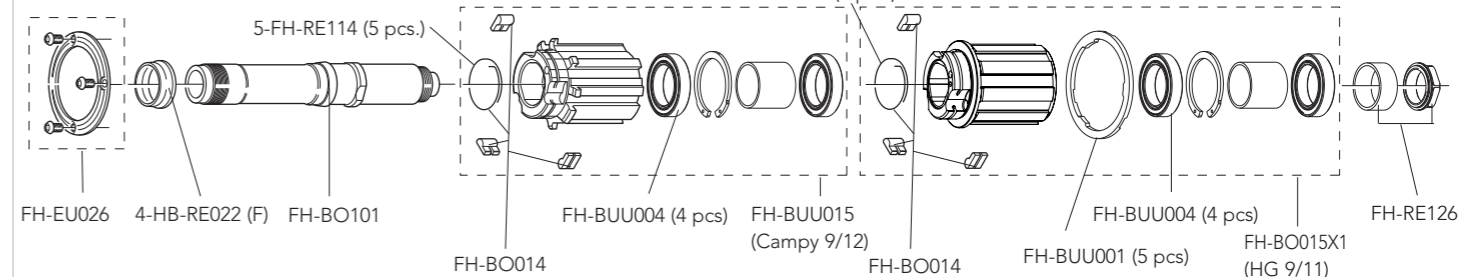

QUICK-RELEASES

QR13-80FR

front + rear

# SHAMAL ULTRA

C17 2-WAY FIT

# SHAMAL ULTRA

C17 2-WAY FIT

## RIM

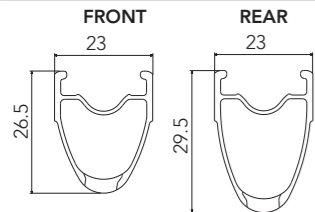

FRONT RIM	WH-313SHB (no labels)
REAR RIM	WH-314SHB (no labels)
LABEL KIT	LAB-SH2B17 (front+rear)
VALVE HOLE	7,5 mm
2-WAY FIT™ VALVE	WH-SH101
VALVE HOLE BUSHING	5-WH-SH002 (for valve seat reduction - 5 pcs)
DIAMETER	634 mm
BRAKE PADS	see "brake pads compatibility table" on <a href="http://www.campagnolo.com">www.campagnolo.com</a>

## SPOKES

FRONT KIT	KIT-23SHB	16 front/rear right spokes
REAR KIT	KIT-34SHB	14 front/rear right spokes + 7 rear left spokes
COMPLETE FRONT SPOKE	WH-205SHB	spoke + nipple
COMPLETE REAR LEFT SPOKE	WH-207SHB	spoke + nipple
COMPLETE REAR RIGHT SPOKE	WH-208SHB	spoke + nipple
NIPPLES	WH-115SH	10 pieces
SPOKE RING	UT-WH010	anti-rotation spokes
NIPPLE INSERT	UT-WH020	magnet-attractor for nipple
NIPPLE MAGNET	UT-WH050	nipple-guide
SPOKE SPANNER	UT-WH070	spoke wrenches

## ACCESSORIES

Spacer for HG11 FW body	FH-BUU001	5 pcs - to be used only with 9/10s sprockets (HG11 FW body package contains the spacer)
-------------------------	-----------	---

## HUBS

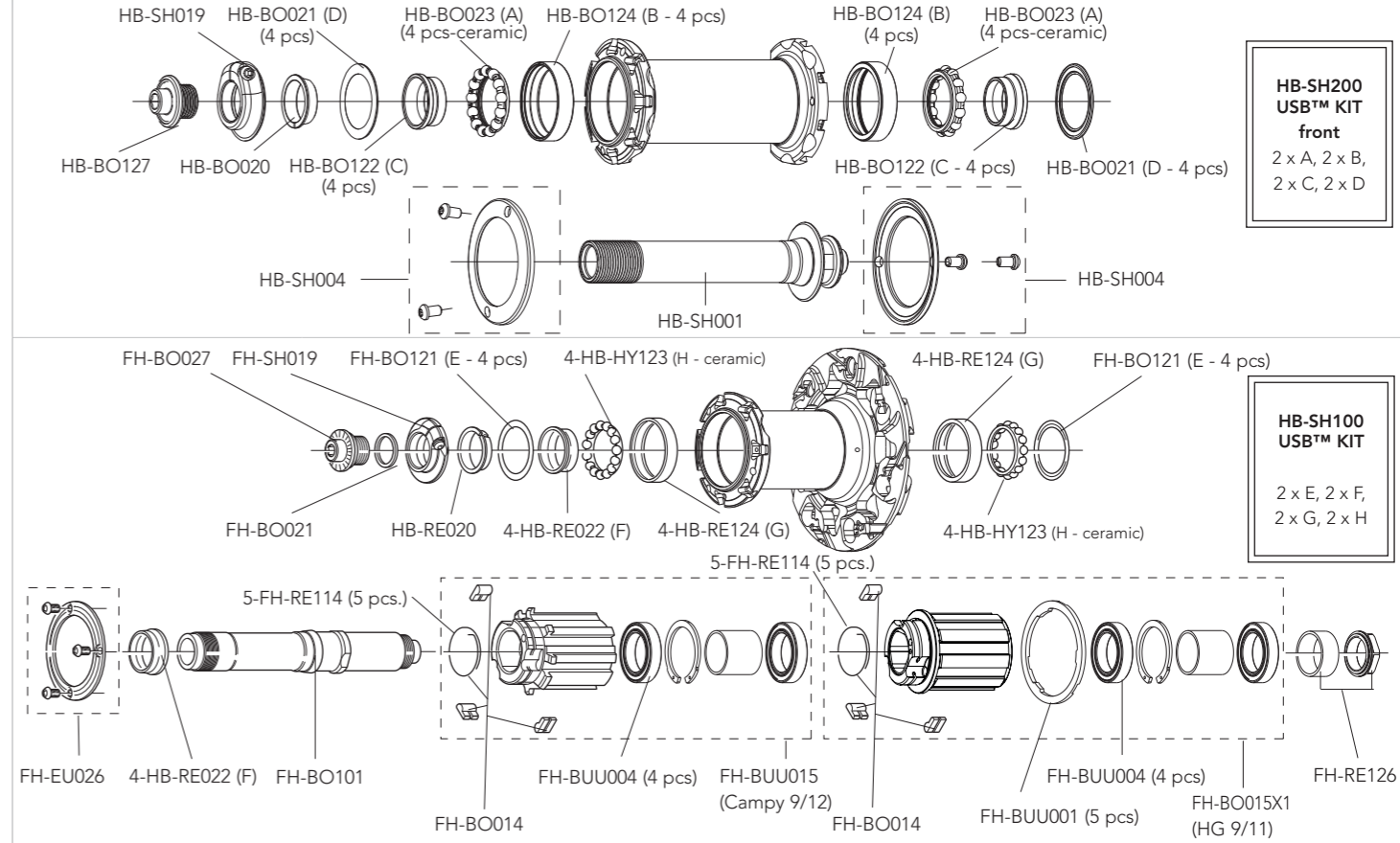

**HB-SH200  
USB™ KIT  
front**  
2 x A, 2 x B,  
2 x C, 2 x D

**HB-SH100  
USB™ KIT**  
2 x E, 2 x F,  
2 x G, 2 x H

QUICK-RELEASES	QR13-80FR	front + rear
----------------	-----------	--------------

# SHAMAL ULTRA

C17 CLINCHER

# SHAMAL ULTRA

C17 CLINCHER

## RIM

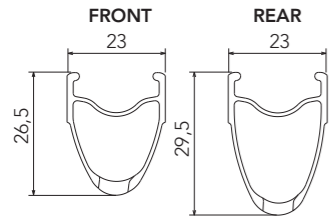

FRONT RIM  
REAR RIM  
LABEL KIT  
VALVE HOLE  
DIAMETER  
BRAKE PADS

WH-403SHB (no labels)  
WH-404SHB (no labels)  
LAB-SHCB17  
6,5 mm  
622 X 17C  
see "brake pads compatibility table" on [www.campagnolo.com](http://www.campagnolo.com)

## SPOKES

FRONT KIT	KIT-23SHB	16 front/rear right spokes
REAR KIT	KIT-34SHB	14 front/rear right spokes + 7 rear left spokes
COMPLETE FRONT	WH-205SHB	spoke + nipple
COMPLETE REAR LEFT SPOKE	WH-207SHB	spoke + nipple
COMPLETE REAR RIGHT SPOKE	WH-208SHB	spoke + nipple
NIPPLES	WH-115SH	10 pieces
SPOKE RING	UT-WH010	anti-rotation spokes
NIPPLE INSERT	UT-WH020	magnet-attracting nipple insert
NIPPLE MAGNET	UT-WH050	nipple attracting magnet
SPOKE SPANNER	UT-WH070	spoke wrenches

## ACCESSORIES

Spacer for HG11 FW body	FH-BUU001	5 pcs - to be used only with 9/10s sprockets (HG11 FW body package contains the spacer)
-------------------------	-----------	--

## HUBS

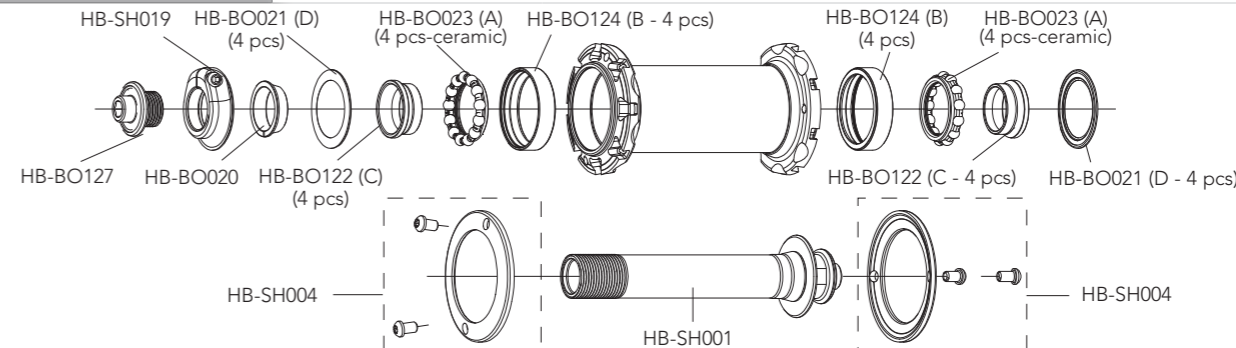

**HB-SH200  
USB™ KIT  
front**  
2 x A, 2 x B,  
2 x C, 2 x D

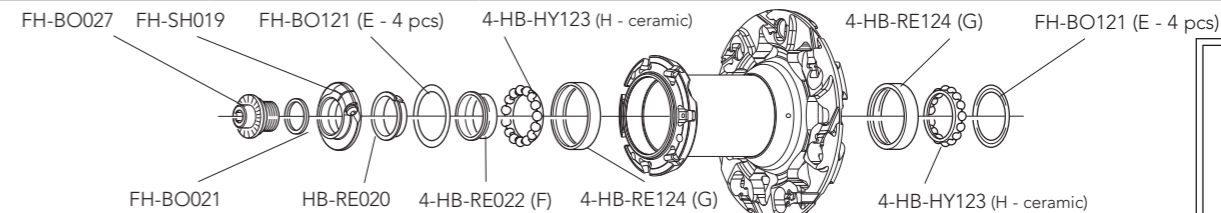

**HB-SH100  
USB™ KIT**  
2 x E, 2 x F,  
2 x G, 2 x H

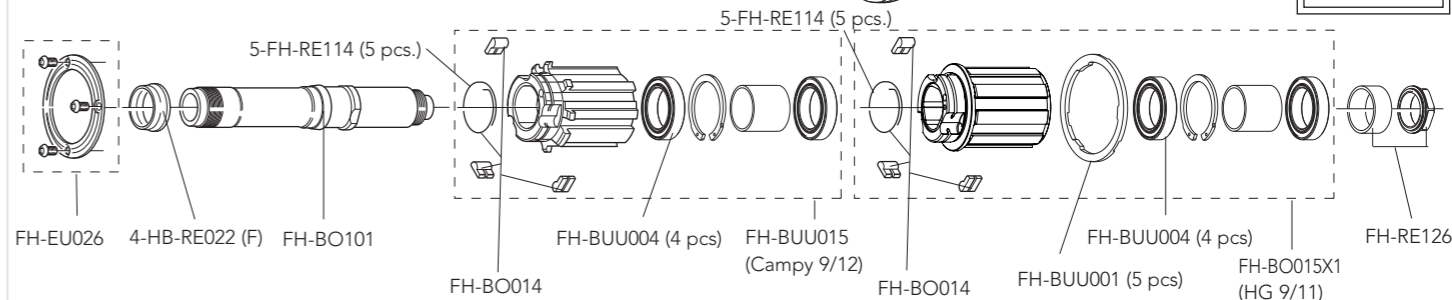

QUICK-RELEASES

QR13-80FR

front + rear

## RIM

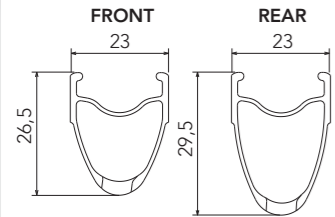

FRONT RIM	WH-403ZOB (with labels)
REAR RIM	WH-504ZOB (with labels)
LABEL KIT	LAB-ZOCB17 (for a pair of front+rear wheels)
VALVE HOLE	6,5 mm
DIAMETER	622 X 17C
BRAKE PADS	see "brake pads compatibility table" on <a href="http://www.campagnolo.com">www.campagnolo.com</a>

## SPOKES

FRONT SPOKE	WH-116ZOC	4 spokes + 4 nipples
REAR RH SPOKE	WH-118ZOC	4 spokes + 4 nipples
REAR LH SPOKE	WH-119ZOC	4 spokes + 4 nipples
NIPPLES	WH-115ZO	50 pieces
NIPPLE INSERT	UT-WH035	magnet-attractor for nipple
NIPPLE MAGNET	UT-WH050	nipple-guide

## ACCESSORIES

Spacer for HG11 FW body	FH-BUU001	5 pcs - to be used only with 9/10s sprockets (HG11 FW body package contains the spacer)
-------------------------	-----------	--

## HUBS

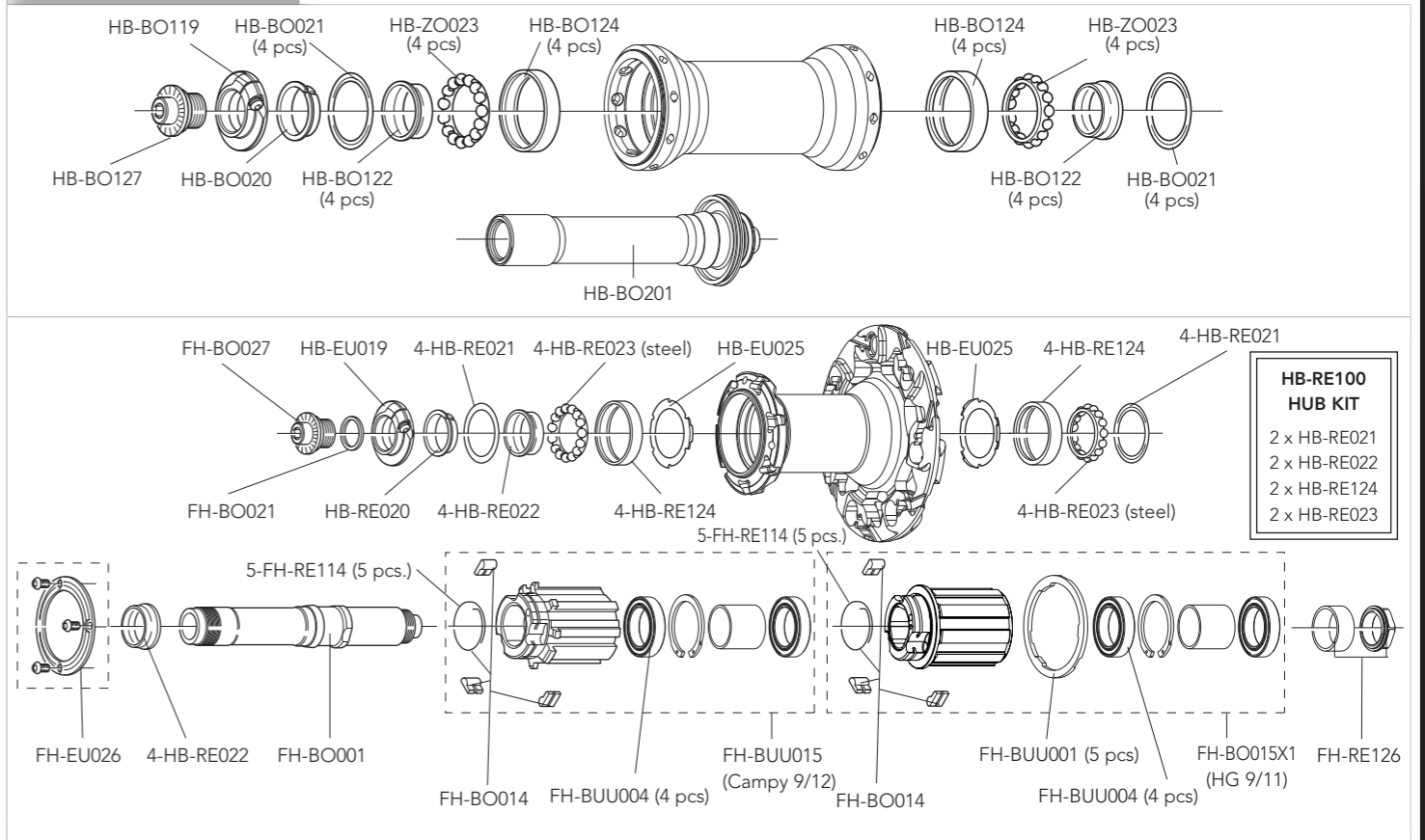

QUICK-RELEASES	QR12-ZOBFR	front + rear
----------------	------------	--------------

## RIM

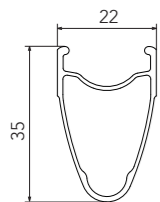

RIM-TAPE	WH-RT003 (2 pieces)
LABEL KIT	LAB-SCCB18 (for a pair of front+rear wheels)
VALVE HOLE	6,5 mm
DIAMETER	622 x 17C
BRAKE PADS	see "brake pads compatibility table" on <a href="http://www.campagnolo.com">www.campagnolo.com</a>

## SPOKES

FRONT SPOKE	WH-016SCC	4 spokes + 4 nipples
REAR RH SPOKE	WH-018SCC	4 spokes + 4 nipples
REAR LH SPOKE	WH-019SCC	4 spokes + 4 nipples

## ACCESSORIES

Spacer for HG11 FW body	FH-BUU001	5 pcs - to be used only with 9/10s sprockets (HG11 FW body package contains the spacer)
-------------------------	-----------	--

## HUBS

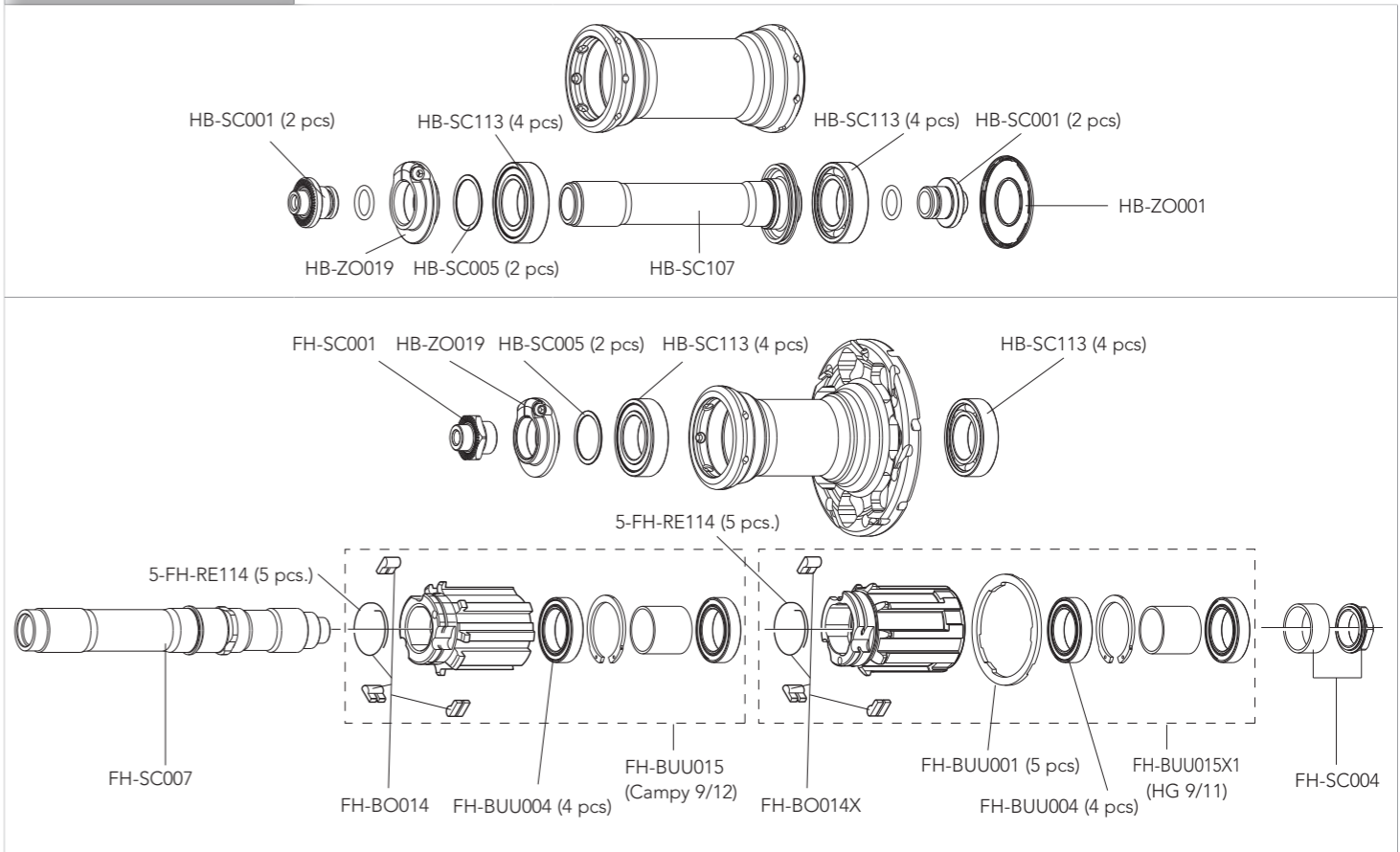

QUICK-RELEASES	QR12-ZOBFR	front + rear
----------------	------------	--------------



## RIM

<b>FRONT</b>	<b>REAR</b>	RIM-TAPE LABEL KIT VALVE HOLE DIAMETER BRAKE PADS	WH-RT003 (20,5 mm - 2 pieces) LAB-KHC19 (front+rear) 6,5 mm 622 X 17C see "brake pads compatibility table" on <a href="http://www.campagnolo.com">www.campagnolo.com</a>

## SPOKES

FRONT SPOKE	WH-116KHC	4 spokes + 4 nipples
REAR RH SPOKE	WH-118KHC	4 spokes + 4 nipples
REAR LH SPOKE	WH-218KHC	4 spokes + 4 nipples

## ACCESSORIES

Spacer for HG11 FW body	FH-BUU001	5 pcs - to be used only with 9/10s sprockets (HG11 FW body package contains the spacer)
-------------------------	-----------	--

## HUBS

The diagrams show the assembly of the front and rear hubs. The front hub assembly includes components: 4-HB-SC013 (4 pcs), HB-ZO002, FH-SC001, FH-KH019, HB-SC005 (2 pcs), HB-SC113 (4 pcs), and HB-SC113 (4 pcs). The rear hub assembly includes: HB-ZO001, 5-FH-RE114 (5 pcs.), FH-SC007, FH-BO014, FH-BUU004 (4 pcs), FH-BUU015 (Campy 9/12), FH-BO014, FH-BUU001 (5 pcs), FH-BUU004 (4 pcs), FH-BUU016X (HG 9/11), and FH-SC004.

QUICK-RELEASES	QR8-40BFR	front + rear
----------------	-----------	--------------

# KHAMSIN ASYMMETRIC G3

CLINCHER

## RIM

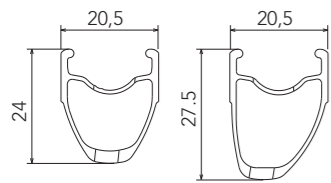

RIM-TAPE  
LABEL KIT  
VALVE HOLE  
DIAMETER  
BRAKE PADS

2-WH-RT12 (18 mm - 2 pieces)  
LAB-KHCB14G3 (BLACK - front+rear)  
6,5 mm  
700C (622 x 15C)  
see "brake pads compatibility table" on [www.campagnolo.com](http://www.campagnolo.com)

## SPOKES

FRONT SPOKE	WH-016KHC	4 spokes + 4 nipples
REAR RH SPOKE	WH-018KHC	4 spokes + 4 nipples
REAR LH SPOKE	WH-119KHC	4 spokes + 4 nipples

## ACCESSORIES

Spacer for HG11 FW body	FH-BUU001	5 pcs - to be used only with 9/10s sprockets (HG11 FW body package contains the spacer)
-------------------------	-----------	--

# KHAMSIN ASYMMETRIC G3

CLINCHER

## HUBS

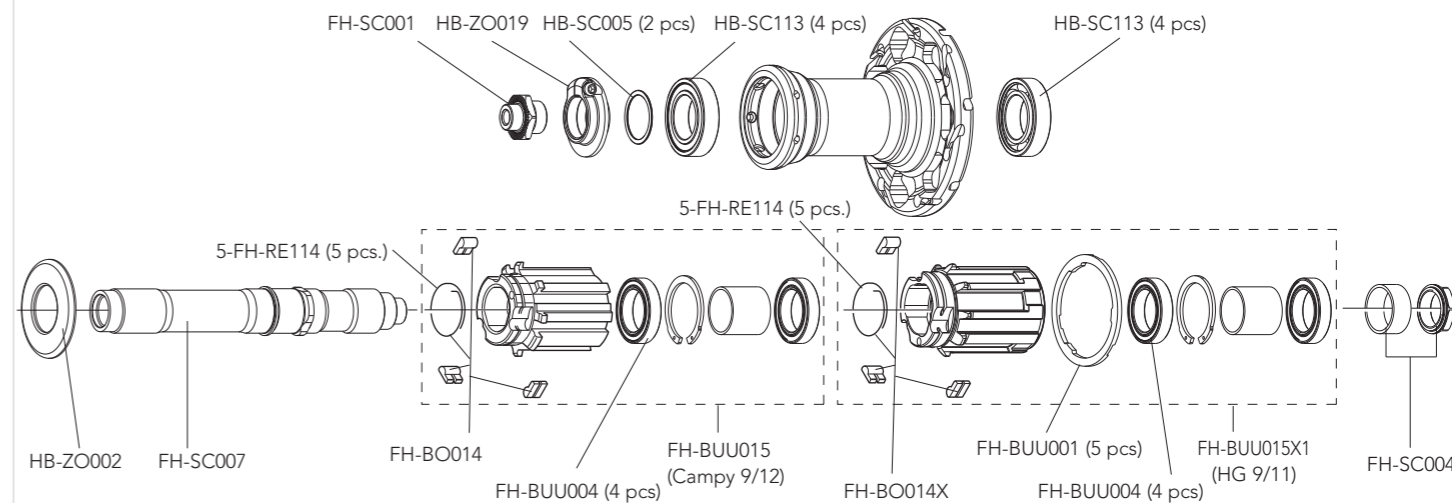
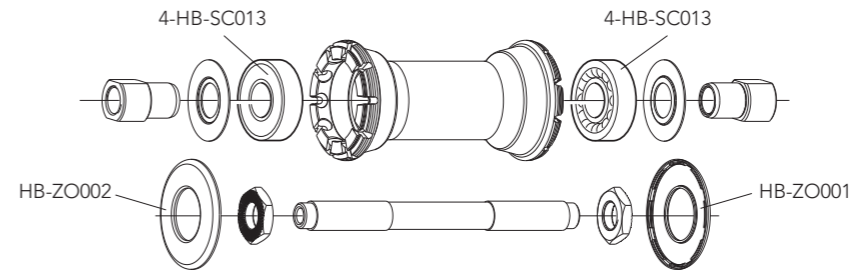

QUICK-RELEASES

QR8-40BFR

front + rear

## RIM

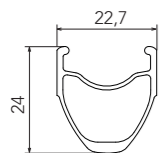

RIM-TAPE	WH-RT003 (20.-5 mm - 2 pieces)
LABEL KIT	LAB-CAC18 (BLACK - front+rear)
VALVE HOLE	6,5 mm
DIAMETER	622 x 17C
BRAKE PADS	see "brake pads compatibility table" on <a href="http://www.campagnolo.com">www.campagnolo.com</a>

## SPOKES

FRONT SPOKE	WH-016CAC	4 spokes + 4 nipples
REAR RH SPOKE	WH-018CAC	4 spokes + 4 nipples
REAR LH SPOKE	WH-019CAC	4 spokes + 4 nipples
NIPPLES	50-WH-NZO	50 pcs

## ACCESSORIES

Spacer for HG11 FW body	FH-BUU001	5 pcs - to be used only with 9/10s sprockets (HG11 FW body package contains the spacer)
-------------------------	-----------	--

## HUBS

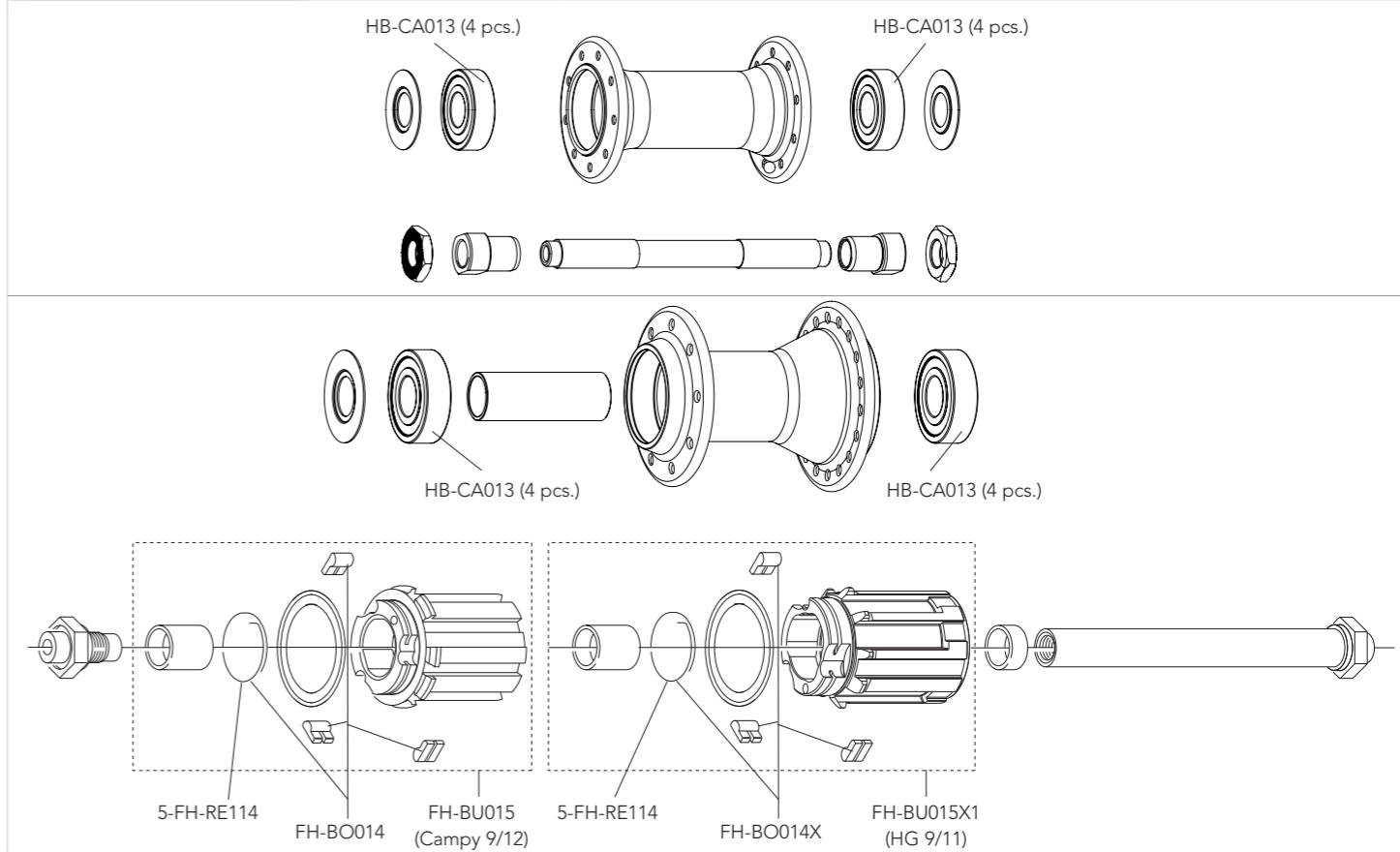

QUICK-RELEASES	QR8-40BFR	front + rear
----------------	-----------	--------------

# BORA ULTRA 80 PISTA

TUBULAR

# BORA ULTRA 80 PISTA

TUBULAR

## RIM

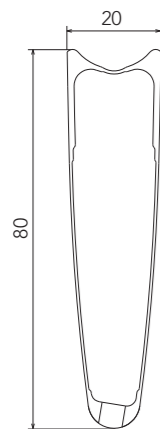

FRONT RIM	WH-101BO80
VALVE HOLE	6,5 mm
VALVE EXTENSION	UT-WH160M (male extension) - UT-WH160F (female extension)
VALVE HOLE BUSHING	WH-BUU002 (5 pcs.) 
DIAMETER	634 mm

## SPOKES

FRONT SPOKE	WH-016BOT80	4 spokes + 4 nipples
NIPPLES	WH-015BO80	black - 10 pieces
NIPPLE INSERT	UT-WH160	magnet-attractor for nipple
NIPPLE MAGNET	UT-WH050	nipple-guide
SPOKE SPANNER	UT-WH090	spoke wrenches

## HUBS

### FRONT TRACK

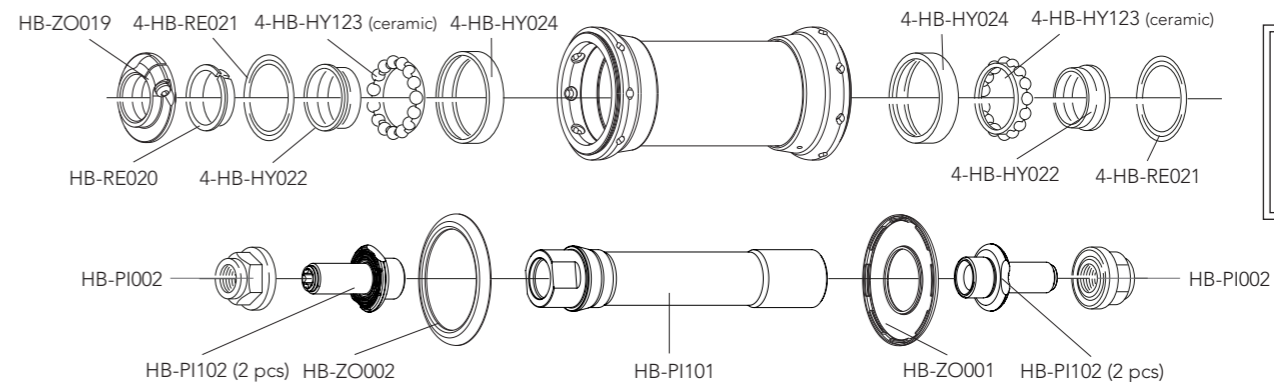

**HB-HY100  
CULT™ KIT**  
2 x HB-RE021  
2 x HB-HY022  
2 x HB-HY024  
2 x HB-HY123

## RIM

VALVE HOLE STICKERS	WH-100BOTT (5 pcs)
VALVE HOLE BUSHINGS	WH-BUU002 (5 pcs.) 
VALVE EXTENSION	UT-WH130M

**HB-BO100  
CULT™ KIT  
front**  
2 x HB-BO023  
2 x HB-BO024  
2 x HB-BO022  
2 x HB-BO021

## HUBS

### FRONT TRACK

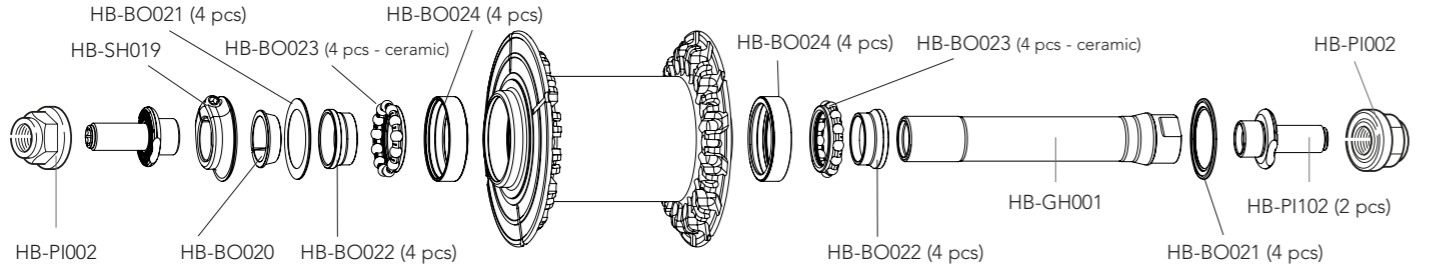

### REAR TRACK

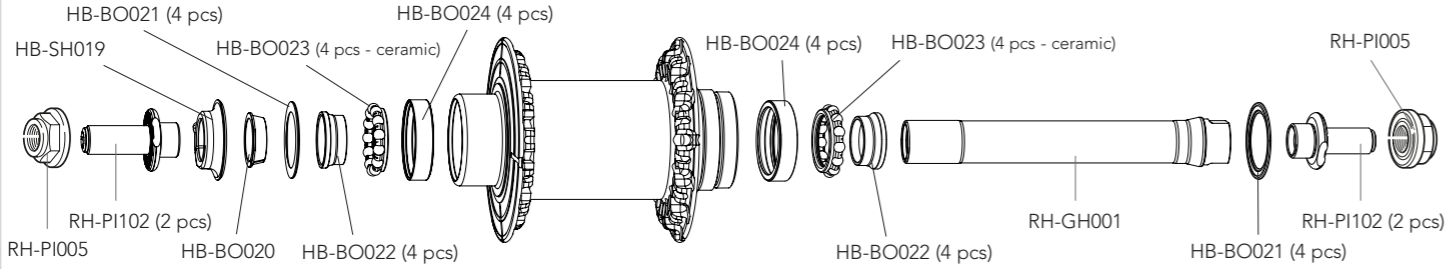

## RIM

VALVE HOLE STICKERS	WH-100BOTT (5 pcs)
VALVE HOLE BUSHINGS	WH-BUU002
VALVE EXTENSION	UT-WH130M
BRAKE SHOES	for carbon rims - BR-BO500 (for brakes with retention spring or interference fixing) - BR-BO500X1 (for brakes with screw fixing)

## ACCESSORIES

Spacer for HG11 FW body	FH-BUU001	5 pcs - to be used only with 9/10s sprockets <i>(please note that every HG11 rear wheel/FW body package contains the spacer)</i>
-------------------------	-----------	---

## HUBS

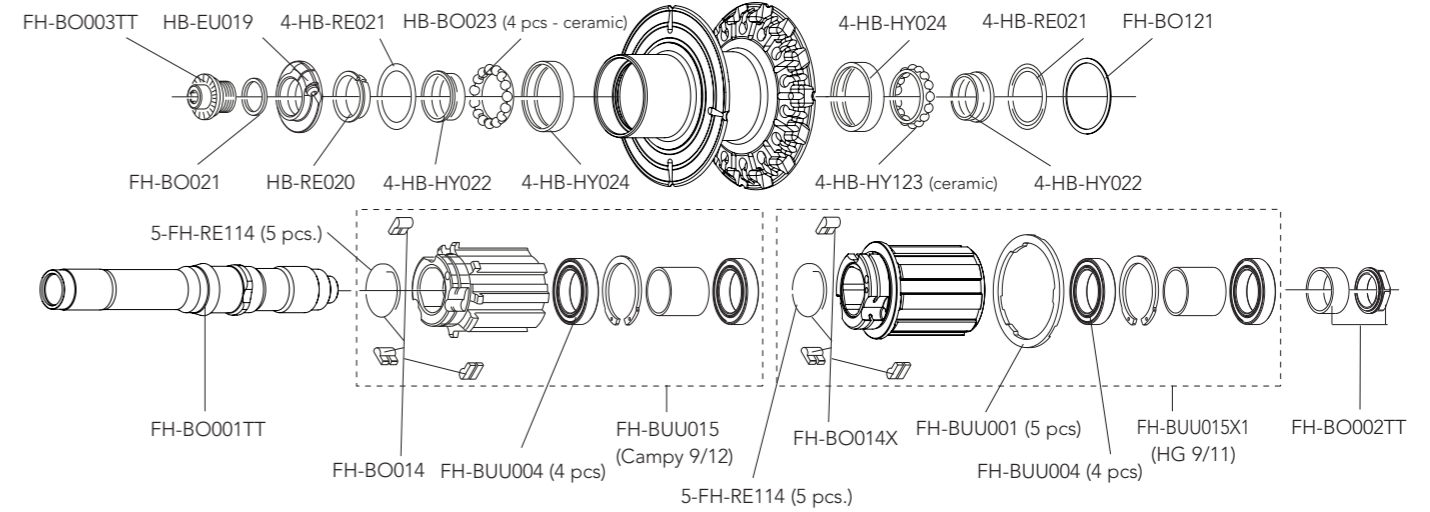

QUICK-RELEASES	QR12-BUUBFR	front + rear
----------------	-------------	--------------

# BORA ONE 50

DB AFS - TUBULAR

# BORA ONE 50

DB AFS - TUBULAR

## RIM

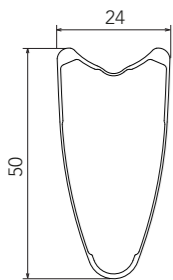

RIM	WH-001BO150DB (bright) - WH-001BO150DBDK (dark)
VALVE HOLE	6,5 mm
VALVE HOLE BUSHING	WH-BUU002 (5 pcs.) 
DIAMETER	700C (622 x 17C)

## SPOKES

FRONT RH L. 262,5	WH-017BO50DB	4 spokes + 4 nipples
FRONT LH / REAR RH L. 278	WH-016BO35DB	4 spokes + 4 nipples
REAR LH L. 253,5	WH-019BO50DB	4 spokes + 4 nipples
NIPPLES	WH-015BO80	black - 10 pieces
NIPPLE INSERT	UT-WH160	magnet-attractor for nipple
NIPPLE MAGNET	UT-WH050	nipple-guide
SPOKE SPANNER	UT-WH090	spoke wrenches

## ACCESSORIES

Spacer for HG11 FW body	FH-BUU001	5 pcs - to be used only with 9/10s sprockets (HG11 FW body package contains the spacer)
AFS™ locking	M1-101	to fix the rotor

## HUBS

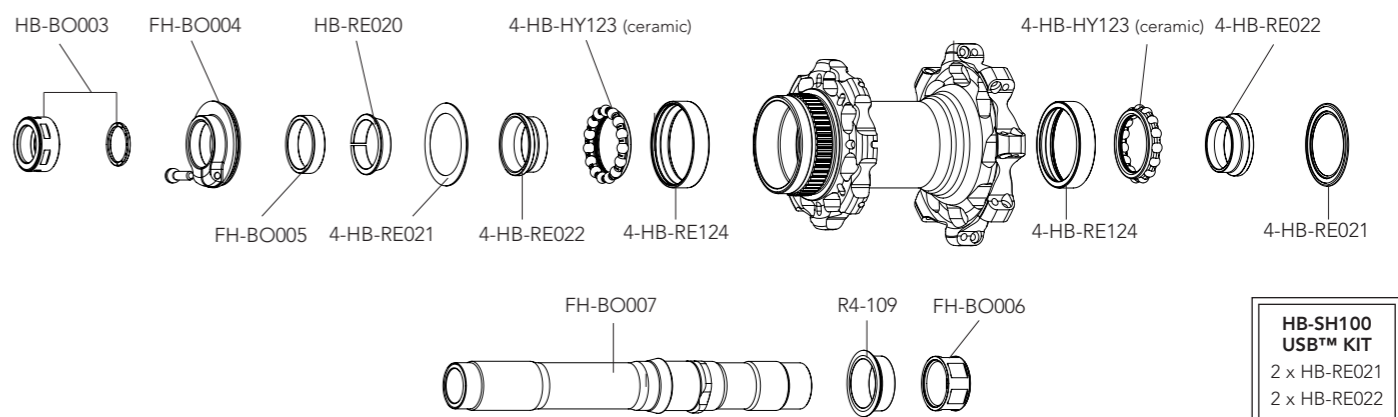
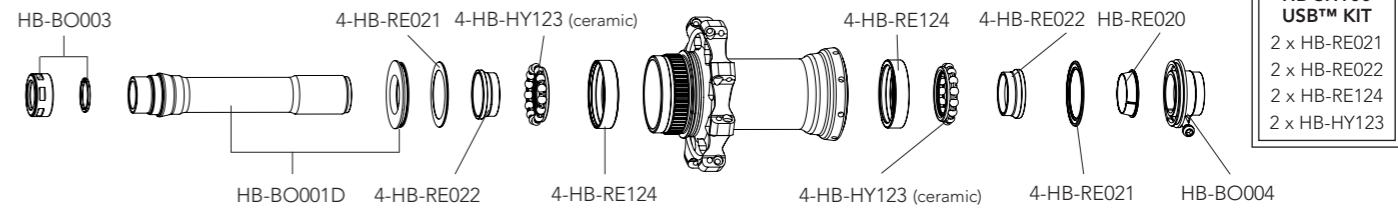



Complete FW body / Corpetti RL completi **FH-BUU015** (Campagnolo 9/12) - **FH-BO015X1** (HG 9/11) - **FH-BU016XDR** (XDR) See exploded view pag. 138

# BORA ONE 35

DB AFS - TUBULAR

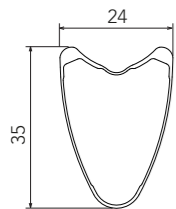
## RIM



RIM	WH-001BO135DB (bright) - WH-001BO135DBDK (dark)
VALVE HOLE	6,5 mm
VALVE HOLE BUSHING	WH-BUU002 (5 pcs.) 
DIAMETER	700C (622 x 17C)

## SPOKES

FRONT LH / REAR RH L. 293	WH-017BO35DB	4 spokes + 4 nipples
FRONT RH L. 278	WH-016BO35DB	4 spokes + 4 nipples
REAR LH L. 268	WH-019BO35DB	4 spokes + 4 nipples
NIPPLES	WH-015BO80	black - 10 pieces
NIPPLE INSERT	UT-WH160	magnet-attractor for nipple
NIPPLE MAGNET	UT-WH050	nipple-guide
SPOKE SPANNER	UT-WH090	spoke wrenches

## ACCESSORIES

Spacer for HG11 FW body	FH-BUU001	5 pcs - to be used only with 9/10s sprockets (HG11 FW body package contains the spacer)
AFS™ locking	M1-101	to fix the rotor

# BORA ONE 35

DB AFS - TUBULAR

## HUBS

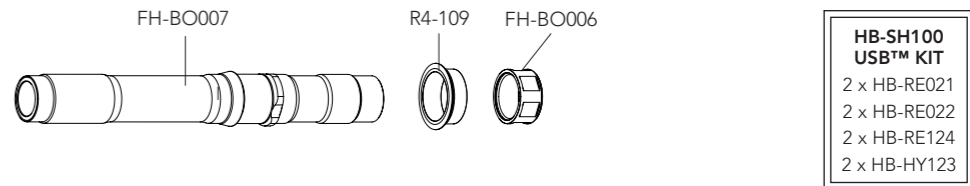
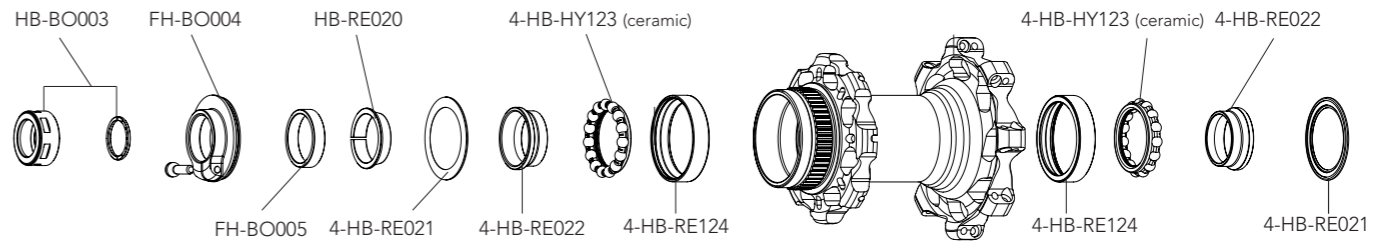
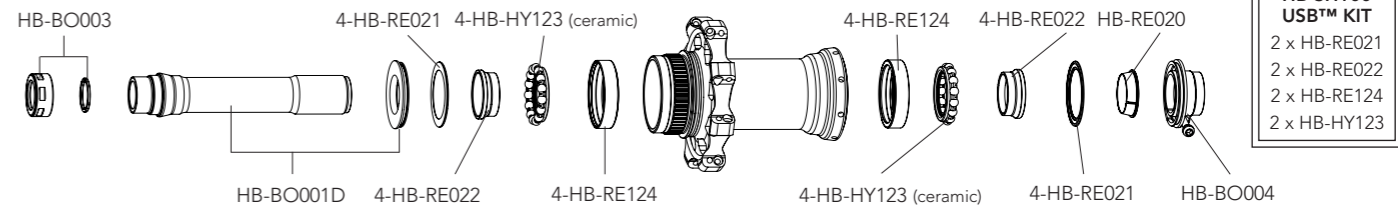

Complete FW body / Corpetti RL completi **FH-BUU015** (Campagnolo 9/12) - **FH-BO015X1** (HG 9/11) - **FH-BU016XDR** (XDR) See exploded view pag. 138

## RIM

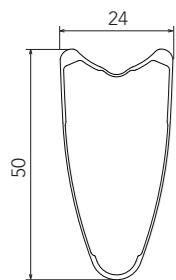

RIM	WH-003BO150DB (bright) - WH-003BO150DBDK (dark)
VALVE HOLE	6,5 mm
VALVE HOLE BUSHING	WH-BUU002 (5 pcs.) 
DIAMETER	700C (622 x 17C)

## SPOKES

FRONT RH L. 262,5	WH-017BO50DB	4 spokes + 4 nipples
FRONT LH / REAR RH L. 278	WH-016BO35DB	4 spokes + 4 nipples
REAR LH L. 253,5	WH-019BO50DB	4 spokes + 4 nipples
NIPPLES	WH-015BO80	black - 10 pieces
NIPPLE INSERT	UT-WH160	magnet-attractor for nipple
NIPPLE MAGNET	UT-WH050	nipple-guide
SPOKE SPANNER	UT-WH090	spoke wrenches

## ACCESSORIES

Spacer for HG11 FW body	FH-BUU001	5 pcs - to be used only with 9/10s sprockets (HG11 FW body package contains the spacer)
AFS™ locking	M1-101	to fix the rotor

## HUBS

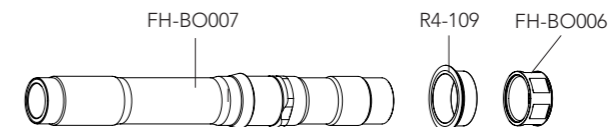
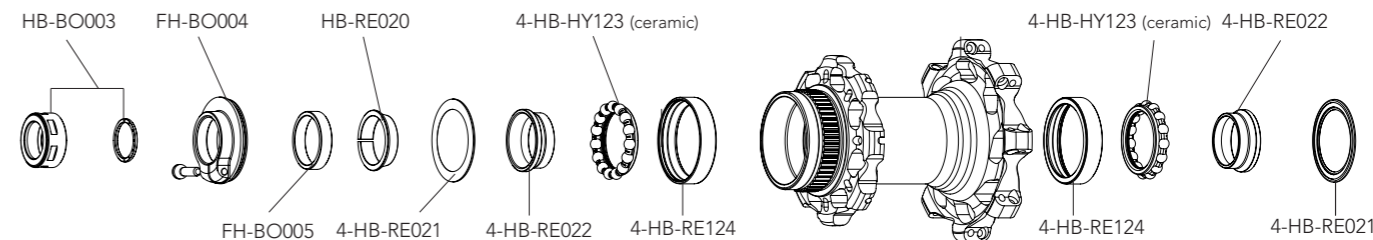
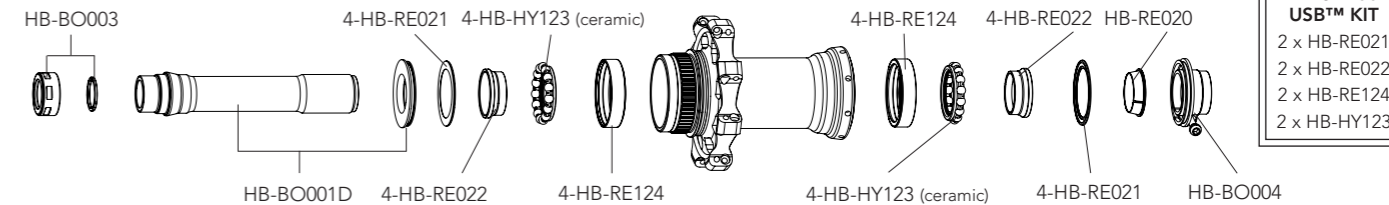





# BORA ONE 35

DB AFS - CLINCHER

# BORA ONE 35

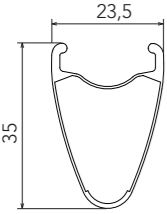
DB AFS - CLINCHER

RIM		
	RIM	WH-003BO135DB (bright) - WH-003BO135DBDK (dark)
	VALVE HOLE	6,5 mm
	VALVE HOLE BUSHING	WH-BUU002 (5 pcs.) 
	DIAMETER	700C (622 x 17C)

SPOKES		
FRONT LH / REAR RH L. 293	WH-017BO35DB	4 spokes + 4 nipples
FRONT RH L. 278	WH-016BO35DB	4 spokes + 4 nipples
REAR LH L. 268	WH-019BO35DB	4 spokes + 4 nipples
NIPPLES	WH-015BO80	black - 10 pieces
NIPPLE INSERT	UT-WH160	magnet-attractor for nipple
NIPPLE MAGNET	UT-WH050	nipple-guide
SPOKE SPANNER	UT-WH090	spoke wrenches

ACCESSORIES		
Spacer for HG11 FW body	FH-BUU001	5 pcs - to be used only with 9/10s sprockets (HG11 FW body package contains the spacer)
AFS™ lockring	M1-101	to fix the rotor

### HUBS

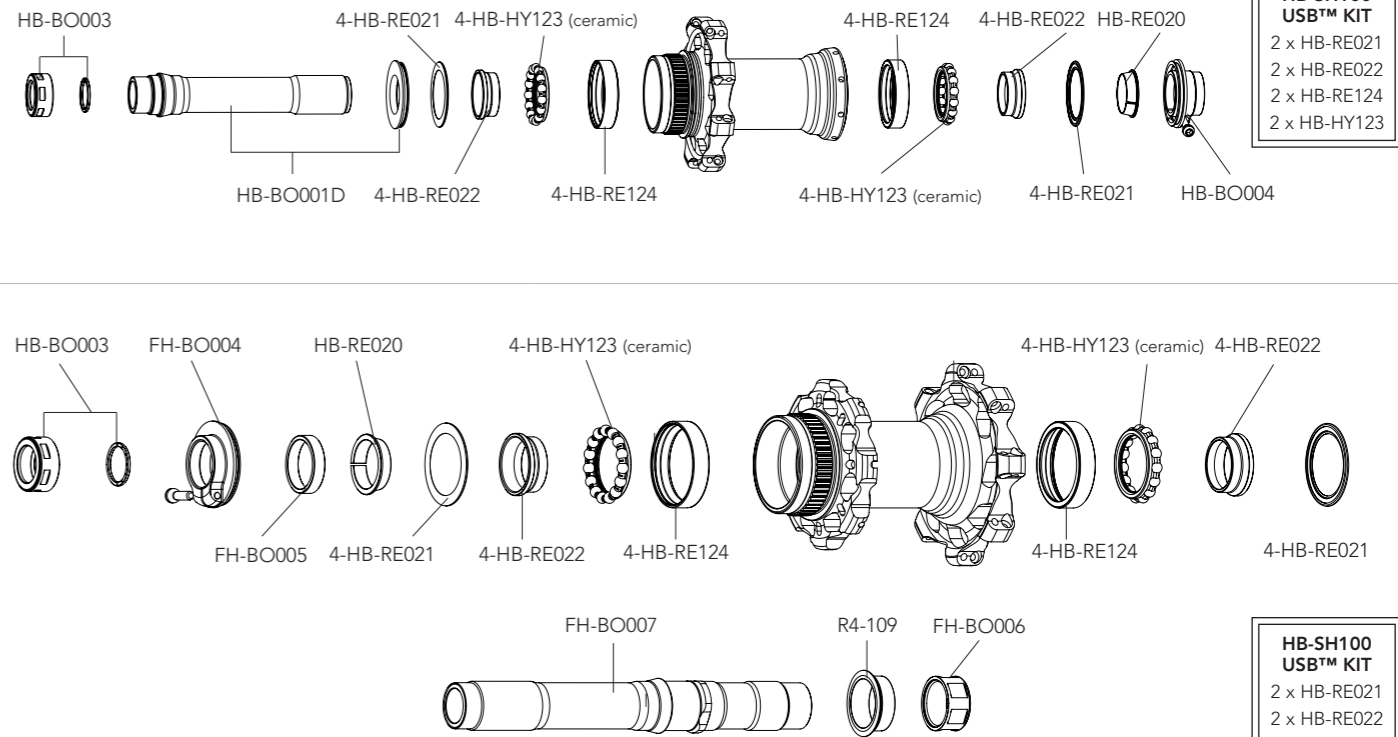



**HB-SH100 USB™ KIT**  
 2 x HB-RE021  
 2 x HB-RE022  
 2 x HB-RE124  
 2 x HB-HY123

**HB-SH100 USB™ KIT**  
 2 x HB-RE021  
 2 x HB-RE022  
 2 x HB-RE124  
 2 x HB-HY123

Complete FW body / Corpetti RL completi **FH-BUU015** (Campagnolo 9/12) - **FH-BO015X1** (HG 9/11) - **FH-BU016XDR** (XDR) See exploded view pag. 138

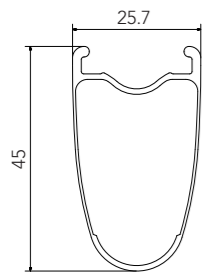
## RIM



RIM	WH-03BWTO45DB (dark)
VALVE HOLE	6,5 mm
VALVE EXTENSION	UT-WH130M (male extension)
2-WAY FIT™ VALVE	WH-SH101
VALVE HOLE BUSHING	WH-BUU002 (5 pcs.) 
DIAMETER	700C (622 x 19C)

## SPOKES

FRONT RH L. 265	WH-02BWTO45	4 spokes + 4 nipples
FRONT LH / REAR RH L. 280,5	WH-04BWTO45DB	4 spokes + 4 nipples
REAR LH L. 261,5	WH-05BWTO45DB	4 spokes + 4 nipples
NIPPLES	WH-07BWTO45DB	black - 10 pieces
NIPPLE INSERT	UT-WH160	magnet-attractor for nipple
NIPPLE MAGNET	UT-WH050	nipple-guide
SPOKE SPANNER	UT-WH090	spoke wrenches

## ACCESSORIES

Spacer for HG11 FW body	FH-BUU001	5 pcs - to be used only with 9/10s sprockets (HG11 FW body package contains the spacer)
AFS™ locking	M1-101	to fix the rotor

## HUBS

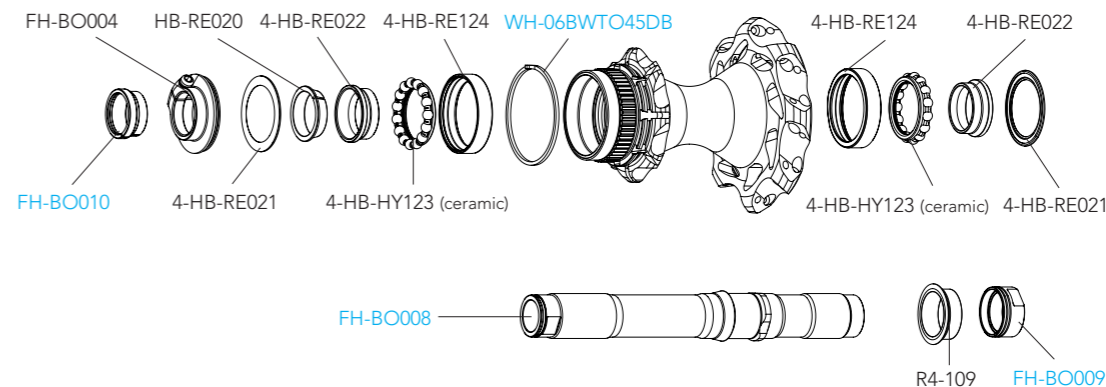
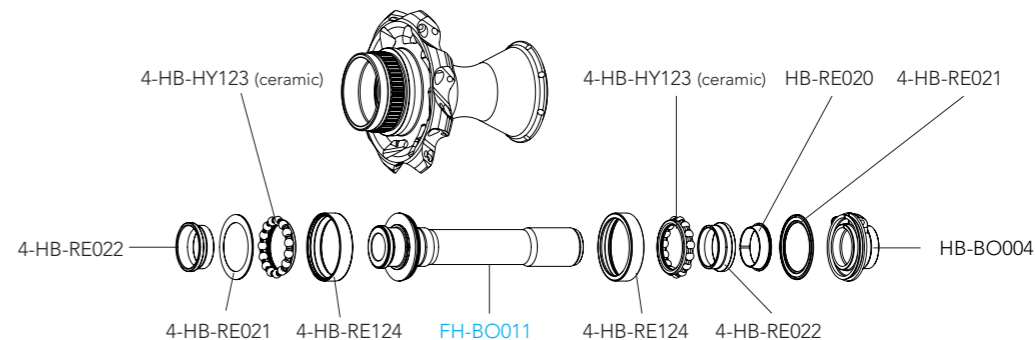

Complete FW body / Corpetti RL completi **FH-BUU015** (Campagnolo 9/12) - **FH-BO015X1** (HG 9/11) - **FH-BU016XDR** (XDR) See exploded view pag. 138

# SHAMAL ULTRA

DB - CLINCHER

# SHAMAL ULTRA

DB - FRONT QR + REAR QR  
DB - FRONT HH12 + REAR HH12

## RIM

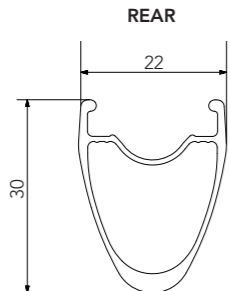
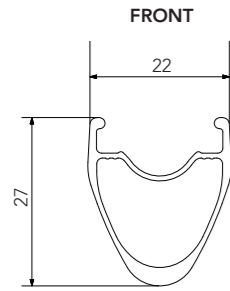

FRONT RIM  
REAR RIM  
LABEL KIT  
LABEL KIT  
FRONT TUBELESS VALVE  
REAR TUBELESS VALVE  
VALVE HOLE  
VALVE HOLE BUSHING  
DIAMETER

WH-001SHDB (without labels)  
WH-002SHDB (without labels)  
LAB-SHDB (front + rear) Bright  
LAB-SHDBD (front + rear) Dark  
WH-SH101 (35 mm)  
VA-2WF44 (44 mm)  
7,5 mm  
5-WH-SH002 (5 pcs)   
622 x 17C

## SPOKES

FRONT LH  
FRONT RH  
REAR RH  
REAR LH  
COMPLETE FRONT KIT  
COMPLETE REAR KIT  
NIPPLES  
NIPPLE INSERT  
NIPPLE MAGNET

WH-016SHDB  
WH-017SHDB  
WH-018SHDB  
WH-019SHDB  
WH-020SHDBF  
WH-020SHDBR  
WH-019SHN  
UT-WH110  
UT-WH050

1 spoke + 1 nipple  
1 spoke + 1 nipple  
1 spoke + 1 nipple  
1 spoke + 1 nipple  
14 left and 7 right spokes  
7 left and 14 right spokes  
Black Aluminium nipple hex 6 mm (10 pcs)  
magnet-attractor for nipple  
nipple guide

## ACCESSORIES

Spacer for HG11 FW body

FH-BUU001

5 pcs - to be used only with 9/10s sprockets  
(HG11 FW body package contains the spacer)

QUICK RELEASE

QR19-FRDB

F+R 135 mm QR SKEWER FOR DB WHEELS

## HUBS

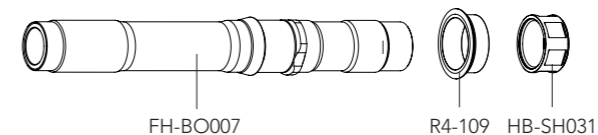
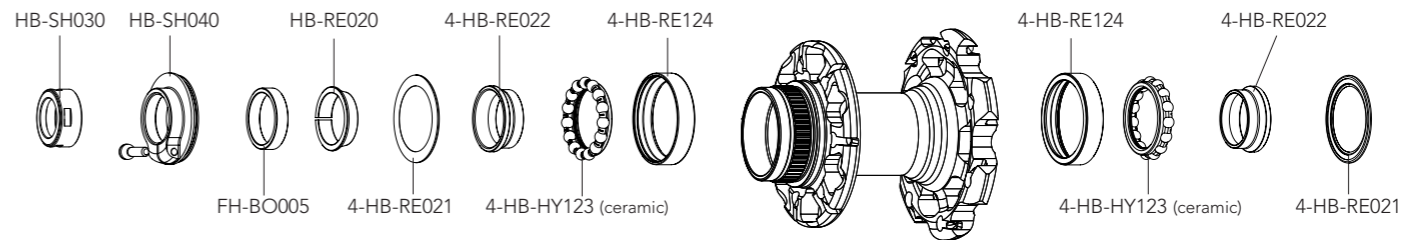
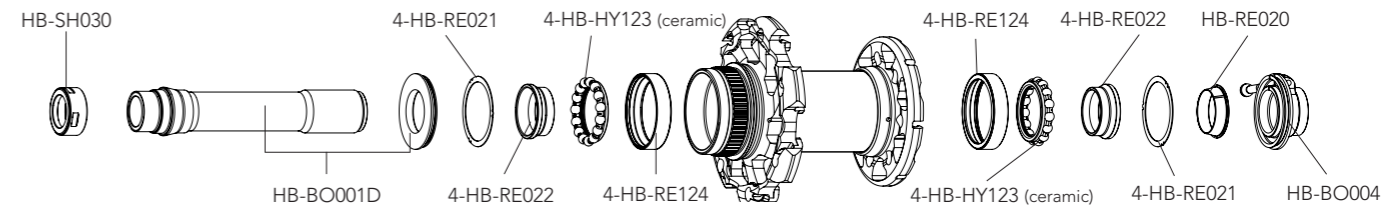

Complete FW body / Corpetti RL completi **FH-BUU015** (Campagnolo 9/12) - **FH-BO015X1** (HG 9/11) - **FH-BU016XDR** (XDR) See exploded view pag. 138

## RIM

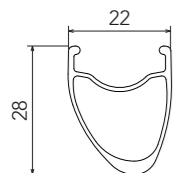

FRONT/REAR RIM	WH-003ZODB (with labels)
LABEL KIT	LAB-ZOCDB17 (for a pair of front+rear wheels)
VALVE HOLE DIAMETER	6,5 mm
	622 X 17C

## SPOKES

FRONT LH / REAR RH SPOKE	WH-016ZODB	4 spokes + 4 nipples
FRONT RH SPOKE	WH-017ZODB	4 spokes + 4 nipples
REAR LH SPOKE	WH-019ZODB	4 spokes + 4 nipples
NIPPLES	50-WH-015ZO	50 pieces
NIPPLE INSERT	UT-WH035	magnet-attractor for nipple
NIPPLE MAGNET	UT-WH050	nipple-guide

## ACCESSORIES

Spacer for HG11 FW body	FH-BUU001	5 pcs - to be used only with 9/10s sprockets (HG11 FW body package contains the spacer)
QUICK-RELEASES	QR17-ZODBFK QR17-ZOBRK	front quick-release + kit QR rear quick-release + kit QR

## HUBS

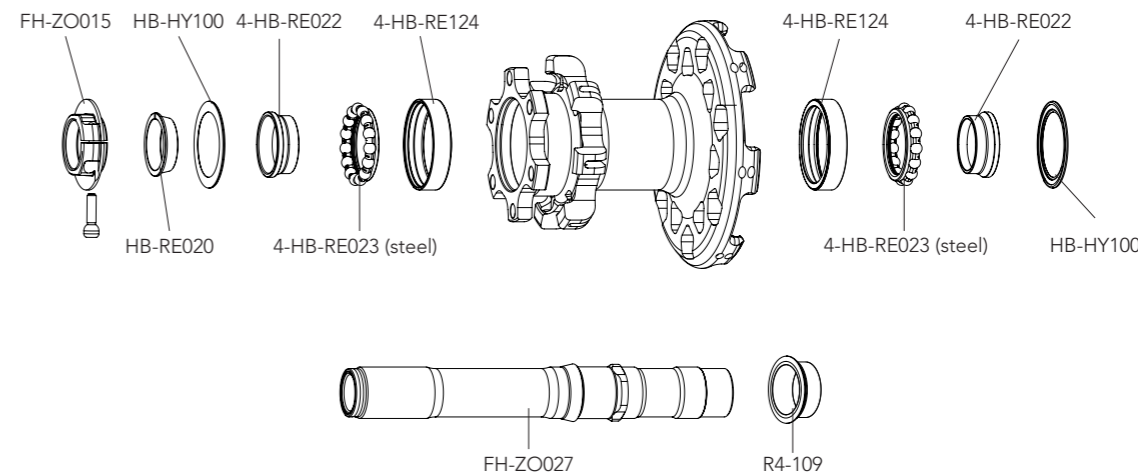
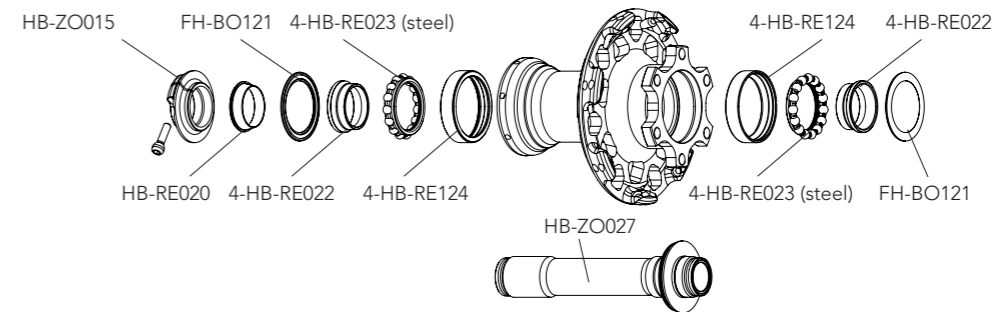

## RIM

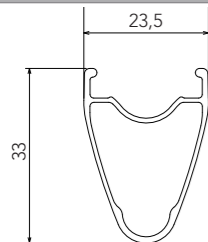

LABEL KIT	LAB-SCDB19 (for a pair of front+rear wheels)
RIM TAPE	2-WH-RT13 (2 pcs)
TUBELESS VALVE	VA-2WF44
VALVE HOLE	6,5 mm
DIAMETER	622 X 19C

## SPOKES

FRONT SPOKE	WH-016SCDB	4 spokes + 4 nipples
REAR RH SPOKE	WH-017SCDB	4 spokes + 4 nipples
REAR LH SPOKE	WH-018SCDB	4 spokes + 4 nipples

## ACCESSORIES

Spacer for HG11 FW body	FH-BUU001	5 pcs - to be used only with 9/10s sprockets (HG11 FW body package contains the spacer)
QUICK RELEASE	QR19-FRDB	Front + Rear 135 mm QR SKEWER FOR DB WHEELS

## HUBS

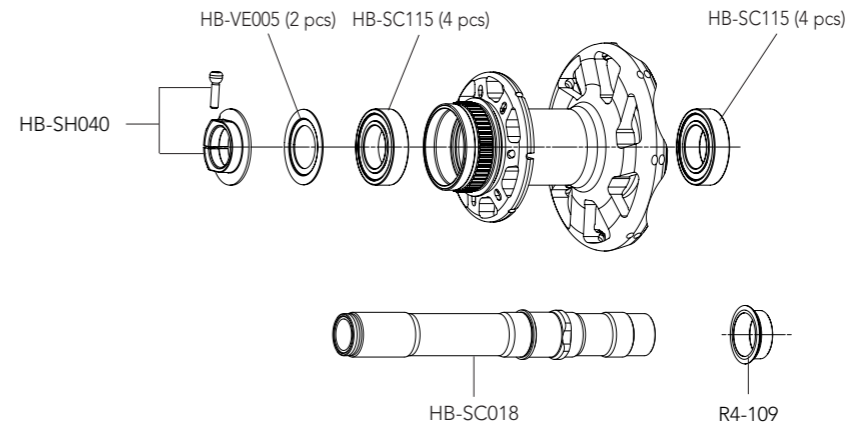
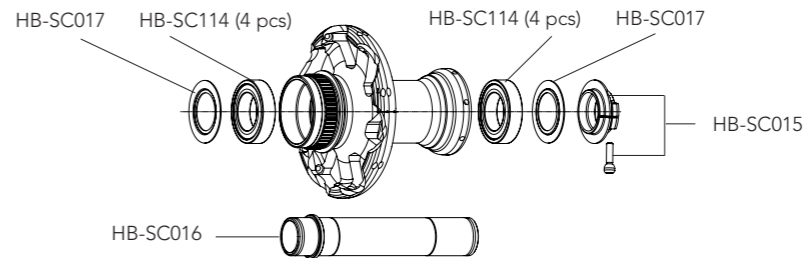

# FW BODIES ROAD WHEELS

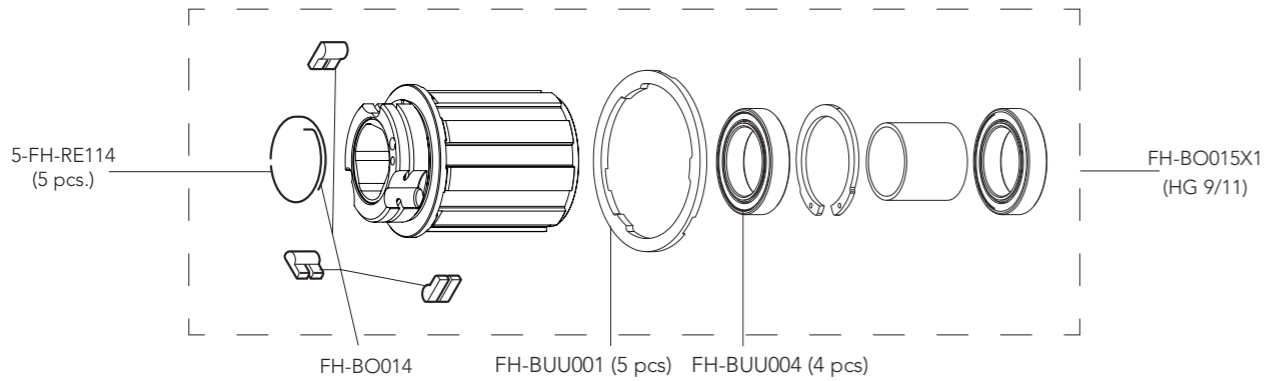
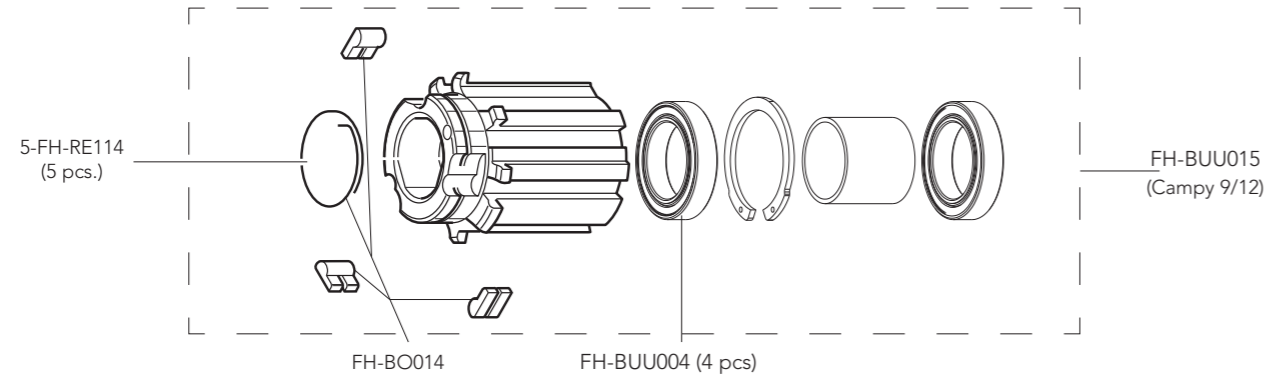

# FW BODIES ROAD WHEELS

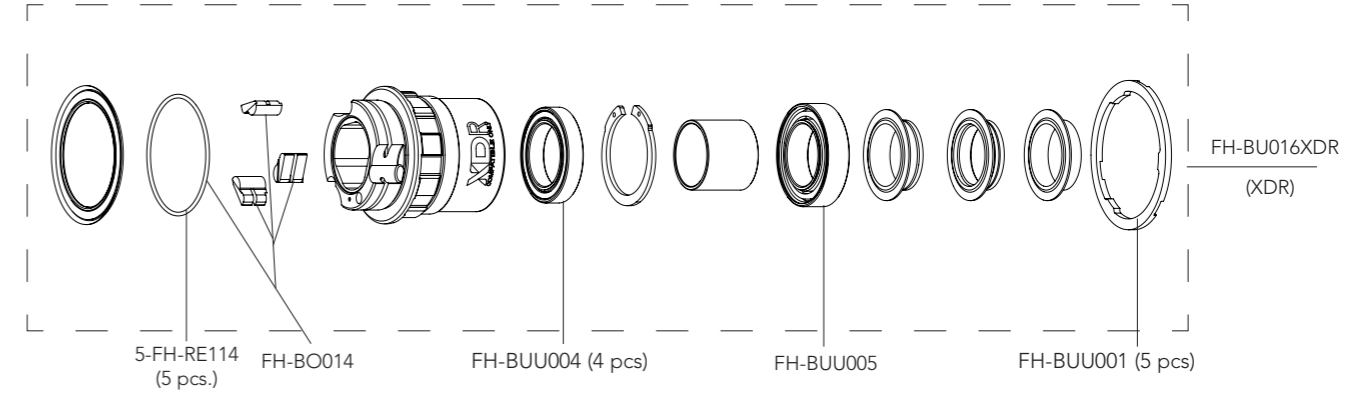

# DB WHEELS - adapters for front axles

# DB WHEELS - adapters for rear axles

ZONDA DB

QR Ø9 mm - 100 mm (KITFCFAQR + KITFCRA12135)

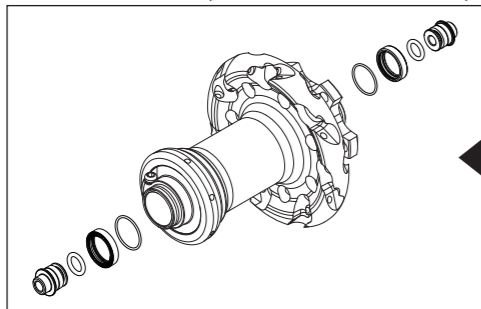

Ø12mm THRU-AXLE - 100mm (KITFCRA12135)

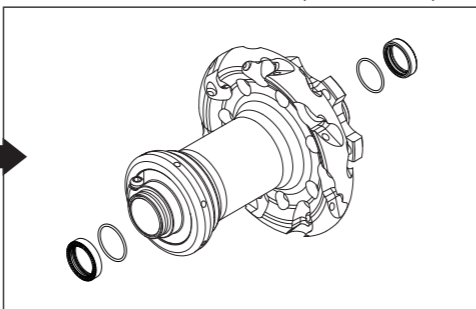

SCIROCCO DB

QR Ø 9mm - 100 mm

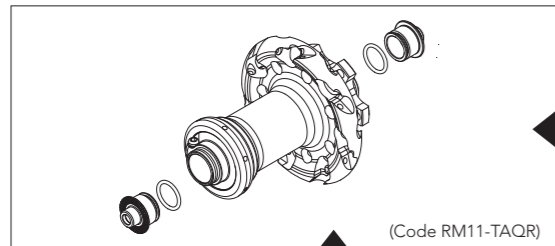

(Code RM11-TAQR)

Ø 12mm THRU-AXLE - 100 mm

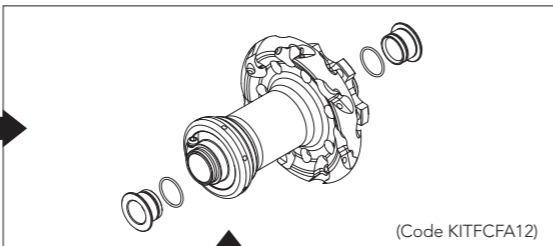

(Code KITFCFA12)

Ø 15mm THRU-AXLE - 100 mm

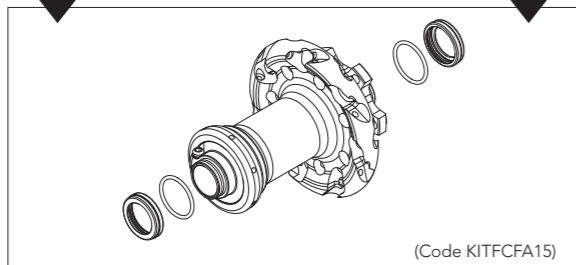

(Code KITFCFA15)

ZONDA DB / SCIROCCO DB

Ø12mm THRU-AXLE- 135 mm

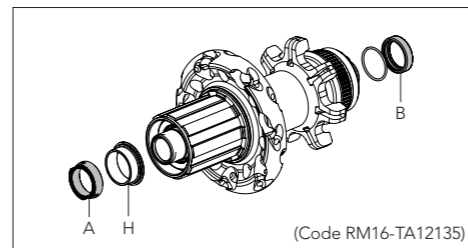

(Code RM16-TA12135)

Ø12mm THRU-AXLE - 142 mm

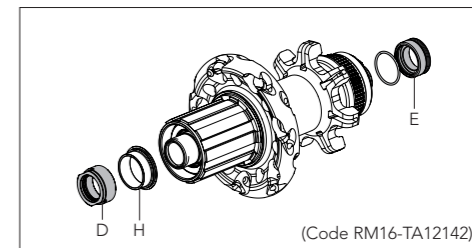

(Code RM16-TA12142)

QR Ø 10 mm - 135 mm

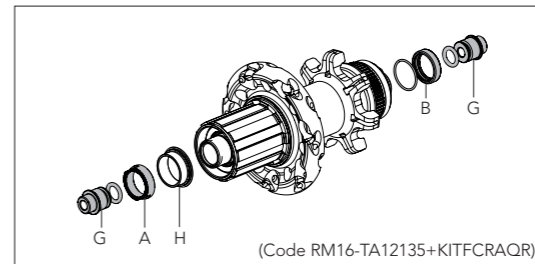

(Code RM16-TA12135+KITFCRAQR)

A	5,6 mm
B	4,25 mm
D	9,1 mm
E	7,75 mm
G	15,5 mm
H*	7,4 mm
H*: code R4-109 (NOT INCLUDED)	

A + B =	code RM16-TA12135
D + E =	code RM16-TA12142
G + G =	code KITFCRAQR

# QUICK-RELEASES

MEDIUM-PROFILE WHEELS		
KHAMSIN™ ASYMMETRIC™		QR8-40BFR
SCIROCCO™		QR12-ZOBFR
ZONDA™		QR12-ZOBFR
SHAMAL™ ULTRA™		QR13-80FR
SHAMAL™ MILLE		QR13-80FR
CARBON HIGH-PROFILE WHEELS		
BORA™ ONE		QR12-BUUBFR
BORA™ ULTRA™		QR12-BUUBFR
BORA™ WTO		QR12-BUUBFR
BORA™ ULTRA™ TT		QR12-BUUBFR
DISC BRAKE WHEELS		
BORA™ ONE 50 DB		QR17-ZOZBFK (front + kit HH=>QR)
BORA™ ONE 35 DB		QR17-ZOZBRK (rear + kit HH=>QR)
BORA™ WTO 40 DB		QR17-ZOZBFK (front + kit HH=>QR)
ZONDA™ DB		QR17-ZOZBFK (front + kit HH=>QR) - QR17-ZOZBRK (rear + kit HH=>QR)
SCIROCCO™ DB		QR19-FRDB
SHAMAL™ ULTRA™ DB		QR19-FRDB

QR12-BUUBFR (front+rear)



QR8-40BFR (front+rear)



QR12-ZOBFR (front+rear)  
QR17-ZOZBFK (front + kit HH=>QR)  
QR17-ZOZBRK (rear + kit HH=>QR)



QR13-80FR (front+rear)



## VALVE EXTENSIONS

Your wheels are supplied with valve extensions that correspond to depth of the rim as follows:

PROFILE RIM	MALE VALVE ADAPTER (SUPPLIED)		
<p>Verificate secondo la lunghezza della valvola (della camera d'aria o del tubolare) e l'altezza del profilo del cerchio, quale sia la prolunga adatta alle vostre esigenze</p> <p>Check what extension you need according to the length of the valve (inner tube or tubular tyre) and height of the rim profile</p>	UT-WH130M	L = 35 mm	
	UT-WH140M	L = 65 mm	
	UT-WH150M	L = 90 mm	
	UT-HU150	L = 40 mm	
	UT-WH160M	L = 74 mm	

PROFILE RIM	FEMALE VALVE ADAPTER (OPTION)		
<p>Verificate secondo la lunghezza della valvola (della camera d'aria o del tubolare) e l'altezza del profilo del cerchio, quale sia la prolunga adatta alle vostre esigenze</p> <p>Check what extension you need according to the length of the valve (inner tube or tubular tyre) and height of the rim profile</p>	UT-WH130F	L = 37 mm	
	UT-WH140F	L = 67 mm	
	UT-WH150F	L = 92 mm	
	UT-WH160F	L = 80 mm	

USE AIR CHAMBERS (INNER TUBES) WITH A LONG VALVE (AT LEAST 35 mm).



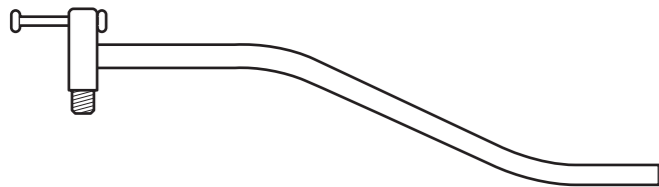

**UT-VS030**  
 Riscontro allineamento occhiello attacco cambio  
 Rear derailleur hanger alignment tool



**UT-FD120**  
 Dima per corretto posizionamento deragliatore (2 pz - per Z50 e Z52)  
 Front derailleur alignment tool (2 pcs - for Z50 and Z52)

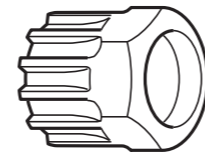

**UT-BB080 (1 pz.) - 10-UT-BB080 (10 pz.):**  
 Chiave per montaggio movimenti centrali CART e ghiera di chiusura pacchi pignoni  
 Cartridge bottom bracket and sprocket cassette- lock ring remover

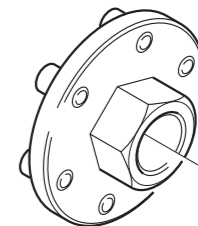

**UT-BB100**  
 Utensile per movimenti a cartuccia Daytona/Centaur™, Veloce™ e Mirage™  
 Tool for Daytona/Centaur™, Veloce™ and Mirage™ cartridge bottom bracket

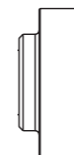

**UT-FC090**  
 Inserto per estrattore pedivella sinistra POWER TORQUE™  
 Insert for left POWER TORQUE™ crank extractor

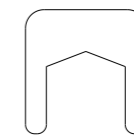

**UT-FC095**  
 Protezione per estrazione pedivella sx POWER TORQUE™  
 (5 pz)  
 shield f. left POWER TORQUE™ crank extractor insert (5 pcs)

# CRANKSET

# BRAKES

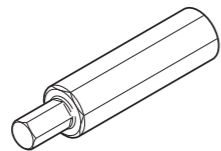

## UT-BB110

Utensile per vite fissaggio guarnitura ULTRA-TORQUE™  
Tool for ULTRA-TORQUE™ crankset fixing screw

## UT-BB130

Chiave per calotte esterne guarnitura / ghiera AFS™  
Tool for crankset overboard cups / AFS™ lockring



## UT-BB240

Utensile per piantaggio calotte integrate OS-Fit™  
Tool for OS-Fit™ crankset overboard cups

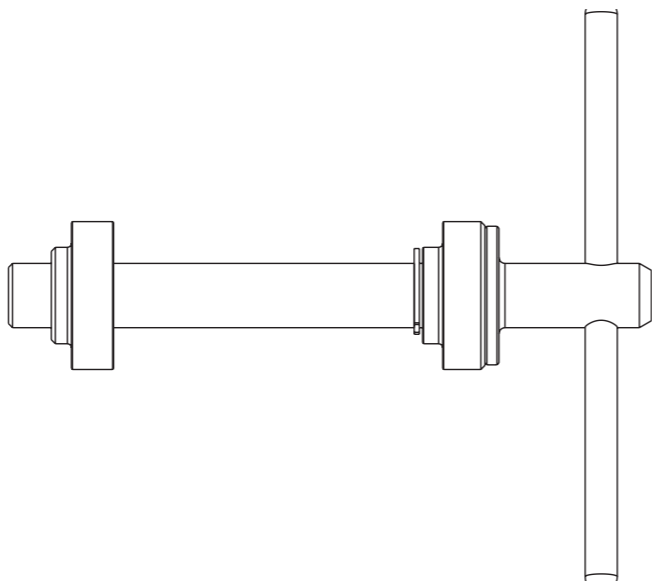
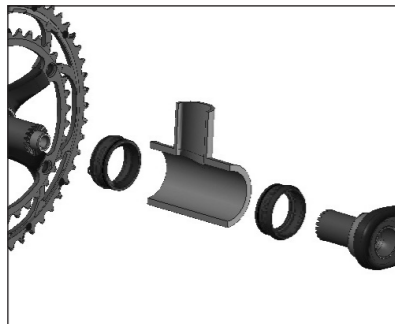

## DISC BRAKES

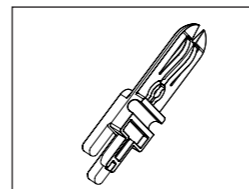

Attrezzo da trasporto /  
Transportation block  
**DB-001** (10 pcs)

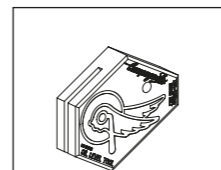

Attrezzo livello olio /  
Oil level tool  
**UT-DB010**

## RIM BRAKES

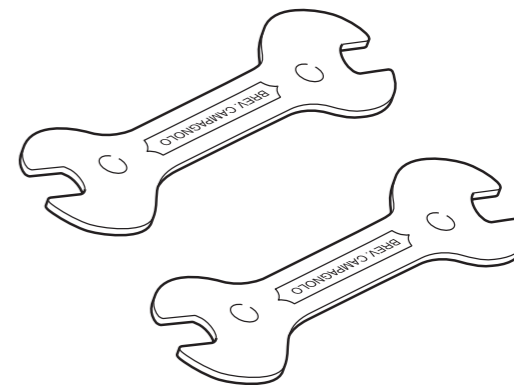

## UT-BR010

Coppia chiavi 13-14 per registrazione freni e coni mozzi  
Pair of 13-14 mm spanners for adjusting brakes and hub cones

# WHEELS

# WHEELS



**UT-WHDB001**  
Chiave per perni esagonali  
Tool for hexagonal axle



**UT-WHDB002**  
Inserto metallico per perni esagonali  
Metallic insert for hexagonal axle

**UT-HU050**  
Tiraraggi  
Spoke wrench

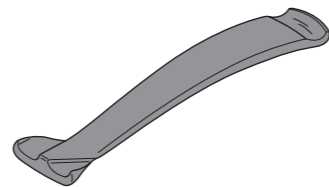
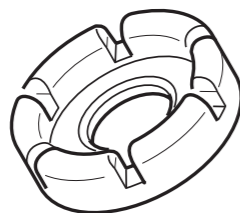

**WH-109HYC (6 pcs.)**  
Leva in composito per rimozione copertoncino  
Composite lever for removing clinchers

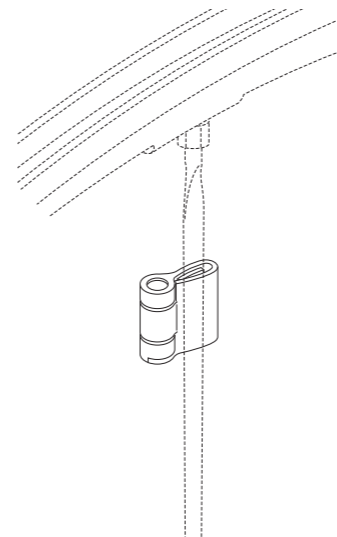

**UT-WH080**  
Magnete velocità per raggi SHAMAL™  
ULTRA™  
SPD magnet for SHAMAL™ ULTRA™  
spokes

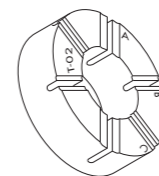

**UT-WH020**  
Inserto nipplo attira-magnete per SHAMAL™ ULTRA / SHAMAL™ MILLE  
Magnet-attracting nipple insert for SHAMAL™ ULTRA / SHAMAL™ MILLE

**UT-WH035**  
Inserto nipplo attira-magnete per ZONDA™ 2012  
Magnet-attracting nipple insert for ZONDA™ 2012

**UT-WH160**  
Inserto nipplo attira-magnete per BORA ULTRA / BORA ULTRA TWO /  
BORA ONE / BORA ONE DB / BORA WTO / BORA WTO DB  
Magnet-attracting nipple insert for BORA ULTRA / BORA ULTRA  
TWO / BORA ONE / BORA ONE DB / BORA WTO / BORA WTO DB

**UT-WH110**  
Inserto nipplo attira-magnete per SHAMAL™ ULTRA DB / SHAMAL™  
MILLE  
Magnet-attracting nipple insert for SHAMAL™ ULTRA DB /  
SHAMAL™ MILLE

**UT-WH010**  
Anello anti-rotazione raggi  
Spoke antirotation ring

**UT-WH090**  
Chiave tiraraggi BORA ULTRA 80  
Spoke wrench BORA ULTRA 80

**UT-WH070**  
Chiave tiraraggi  
Spoke wrench

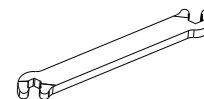

**UT-WH270**  
Chiave tiraraggi per SHAMAL MILLE MY2017 (Service Center Only)  
Spoke wrench for SHAMAL MILLE MY2017 (Service Center Only)

**UT-WH280**  
Chiave tiraraggi per BORA ONE / BORA ULTRA / BORA WTO /  
ZONDA (Nipplo sez. quadrata - Service Center Only)  
Spoke wrench for BORA ONE / BORA ULTRA / BORA WTO / ZONDA  
(Square section nipple - Service Center Only)



# WHEELS



## UT-WH050

Magnete guida-nipplo  
Nipple guide magnet

## 5-WH-SH002

Bussola riduzione sede valvola 2WF (5 pz)  
Valve hole bushing for 2WF (5 pcs)

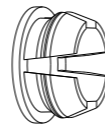

## WH-BUU002

Bussola riduzione sede valvola BORA ULTRA 80 (5 pz)  
Valve hole bushing for BORA ULTRA 80 (5 pcs)

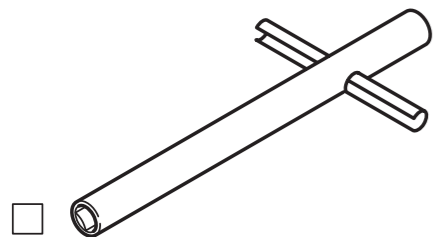
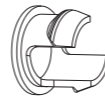

## UT-HU060

Chiave per raggi ruote Bora™ (fino a gamma '02)  
Bora™ wheel truing tool (till '02 range)

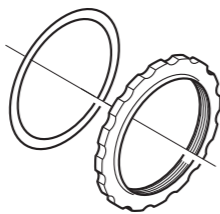

## M1-101 (4 pcs.)

Ghiera AFS™  
AFS™ locking

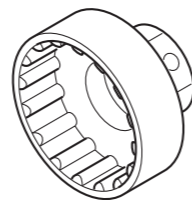

## UT-BB130

Chiave per calotte esterne guarnitura / ghiera AFS™  
Tool for crankset overboard cups / AFS™ locking

# SPROCKETS

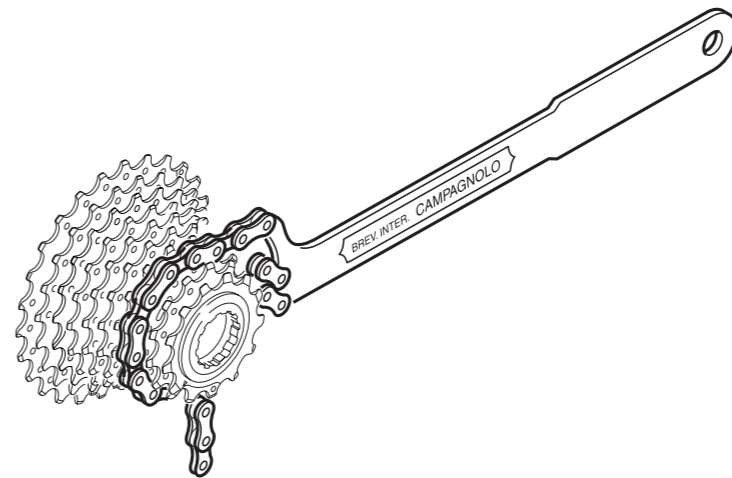

## UT-CS060

Chiave con catena 10s per smontaggio pignoni 11s, 10s, 9s e 8s  
Spanner with 10s chain for 11, 10, 9 and 8s sprockets

# CHAIN

## UT-CN300

Utensile per *Ultra-Link™* (solo catene 11s / 12s)  
Tool for *Ultra-Link™* (11s / 12s chains only)

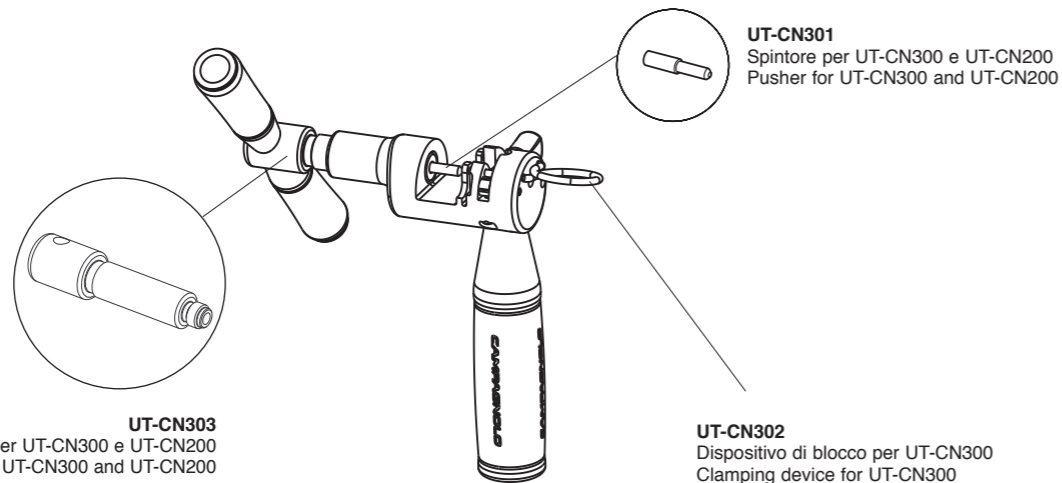

**UT-CN301**  
Spintore per UT-CN300 e UT-CN200  
Pusher for UT-CN300 and UT-CN200

**UT-CN303**  
Perno centrale per UT-CN300 e UT-CN200  
Central axle for UT-CN300 and UT-CN200

**UT-CN302**  
Dispositivo di blocco per UT-CN300  
Clamping device for UT-CN300

# CHAIN

## CAMPY™ UT-CN200

Utensile per *HD-Link™* (catene C10™ e C10™ Ultra Narrow™)  
Tool for *HD-Link™* (C10™ and C10™ Ultra Narrow™ chains)

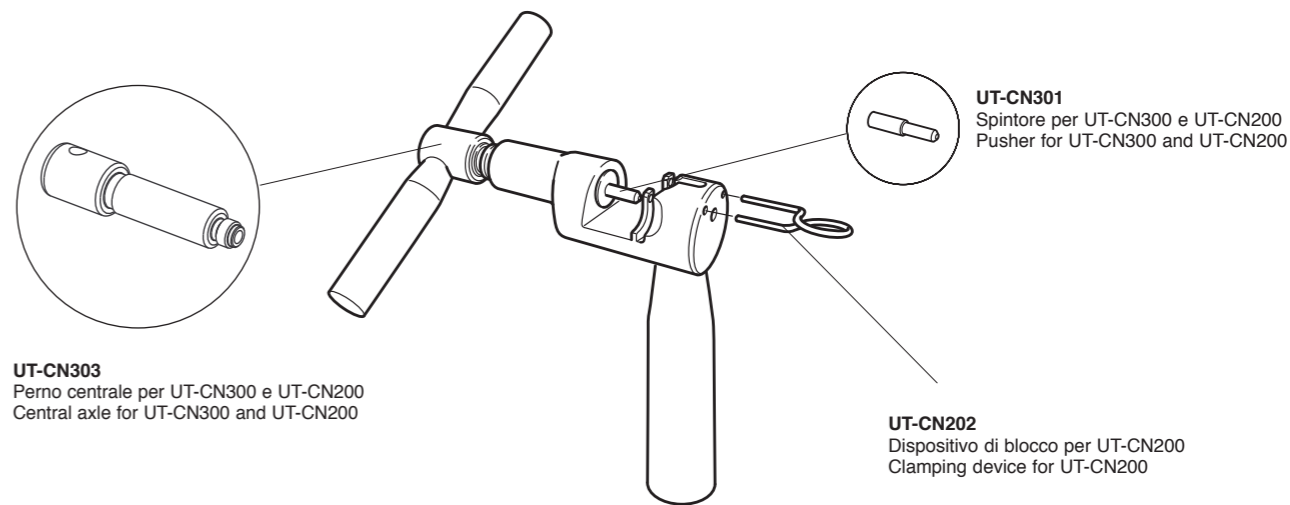

**UT-CN301**  
Spintore per UT-CN300 e UT-CN200  
Pusher for UT-CN300 and UT-CN200

**UT-CN303**  
Perno centrale per UT-CN300 e UT-CN200  
Central axle for UT-CN300 and UT-CN200

**UT-CN202**  
Dispositivo di blocco per UT-CN200  
Clamping device for UT-CN200

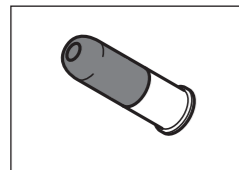

### 5-CN-RE500

*Ultra-Link™* per catene 11s (5 pz)  
*Ultra-Link™* for 11s chains only (5 pcs)

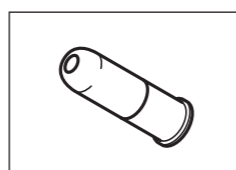

### 5-CN-SR600

*Ultra-Link™* per catene 12s (5 pz)  
*Ultra-Link™* for 12s chains only (5 pcs)

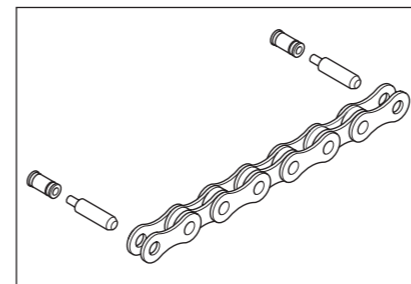

### CN-RE400

*HD-Link™ Ultra Narrow™* (5,9 mm) per catene C10™ Ultra Narrow™  
*HD-Link™ Ultra Narrow™* (5,9 mm) for C10™ Ultra Narrow™ chains

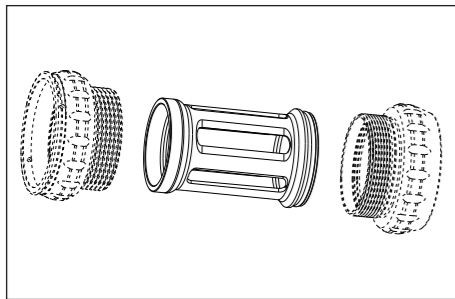

**EPS-001**  
Cilindro guida-cavi  
BB cable guide

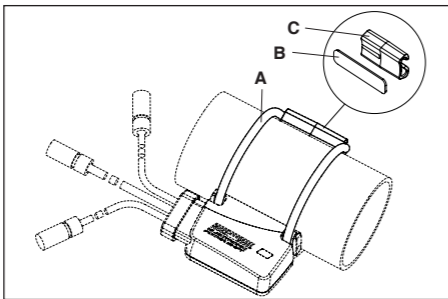

**EPS-002**  
Accessori montaggio sistema di interfaccia (A+B+C)  
Kit for interface assembly (A+B+C)

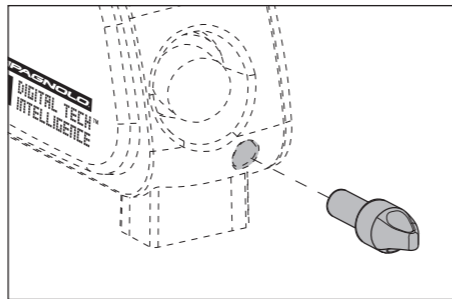

**EPS-003**  
Magnete spegnimento sistema di potenza (5 pz.)  
Switch-off magnet (5 pcs.)

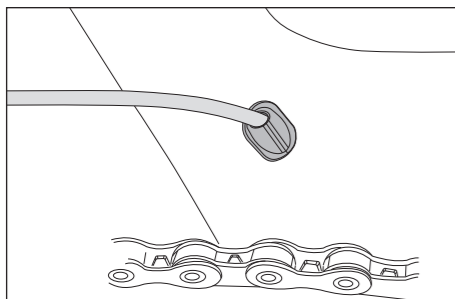

**CG-CS001EPS**  
Gommino passacavi (20 pz.)  
Grommet for cables (20 pcs.)

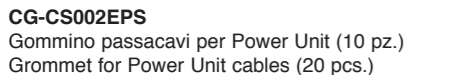

**CG-CS002EPS**  
Gommino passacavi per Power Unit (10 pz.)  
Grommet for Power Unit cables (20 pcs.)

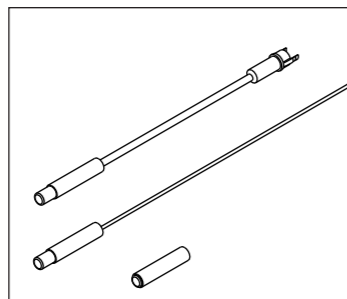

**UT-CG010EPS**  
Kit magneti passacavi SR-RE  
Cable run magnet kit SR-RE



**UT-CG010ATEPS**  
Kit magneti passacavi AT  
Cable run magnet kit AT

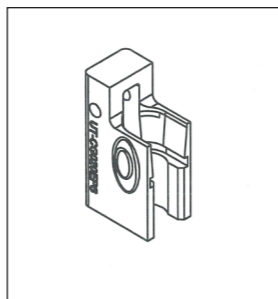

**UT-CG020EPS**  
Attrezzo apri-connettori SR-RE  
Connector disconnection tool SR-RE



**UT-CG120ATEPS**  
Attrezzo apri-connettori AT  
Connector disconnection tool AT

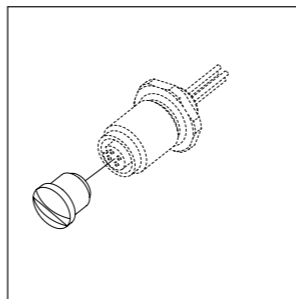

**EPS-004**  
Tappo connettore carica batterie  
PU EPS V2 (5 pz)  
PU EPS V2 connector cup (inter-  
nal mount) (5 pcs)

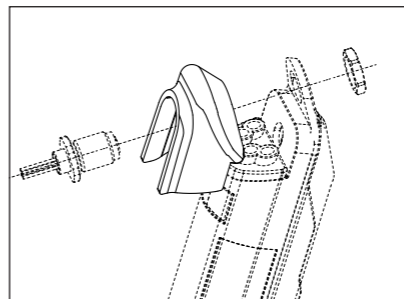

**EPS-005**  
Cappuccio per installazione est. PU EPS V2  
(5pz)  
PU EPS V2 external mount connctor cap  
(5pcs)

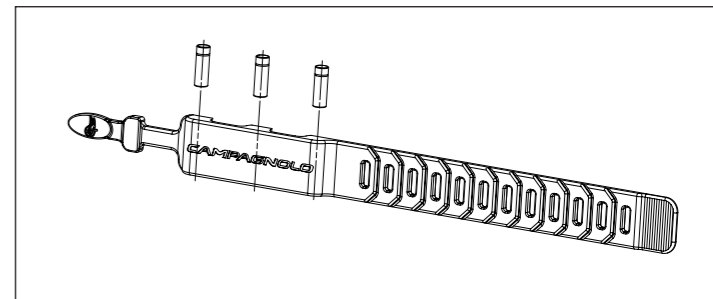

**EPS-006**  
Fascia spegnimento magnetica  
Magnetic power block strap

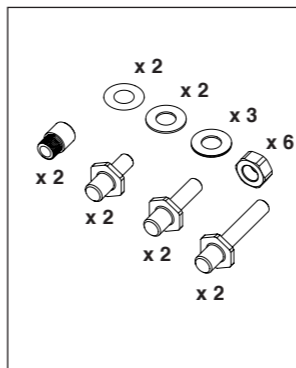

**EPS-107**  
Kit viti Power Unit EPS V2 / V3  
/ V4  
EPS V2 / V3 / V4 Power Unit  
screws kit

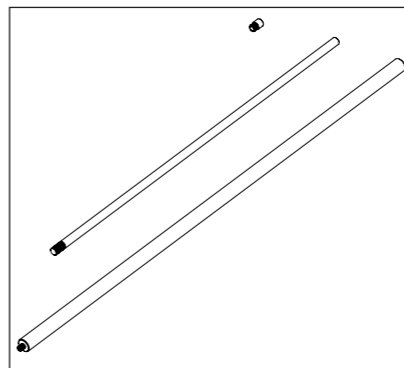

**UT-PU010**  
Kit installazione interna PU EPS V2 /  
V3 / V4  
EPS V2 / V3 / V4 PU internal installation  
tool

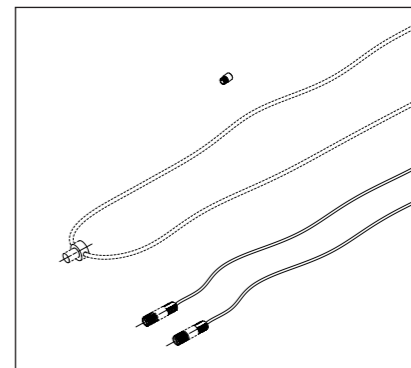

**UT-PU030**  
Kit installazione tubo obliquo  
PU EPS V2  
EPS V2 PU down-tube  
installation tool

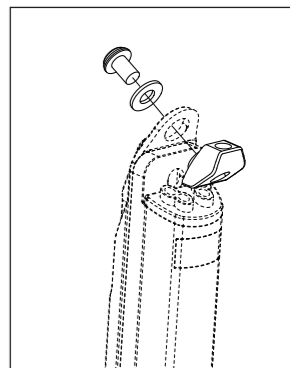

**UT-PU020**  
Adattatore per installazione  
rovesciata PU EPS V2  
EPS V2 PU internal upside-  
down installation adapter



**CAMPAGNOLO S.R.L.**

Via della Chimica, 4  
36100 Vicenza - ITALY  
Tel. +39-0444-225500  
Fax: +39-0444-225400  
E-mail: sales@campagnolo.com

**FRANCE**

CAMPAGNOLO FRANCE SAS  
ZA du Tissot - 42530 St GENEST -  
LERPT  
Tel. +33-477-556305  
Fax: +33-477-556345  
E-mail: campagnolo@campagnolo.fr

**GERMANY**

CAMPAGNOLO DEUTSCHLAND  
GMBH  
Alte Garten 62  
51371 LEVERKUSEN  
Tel. +49-214-206953-0  
Fax: +49-214-206953-15  
E-mail: campagnolo@campagnolo.de

**JAPAN**

CAMPAGNOLO JAPAN LTD  
65 Yoshida-cho, Naka-ku,  
YOKOHAMA  
231-0041  
Tel. +81-45-264-2780  
Fax: +81-45-241-8030  
E-mail: info@campagnolo.jp

**SPAIN**

CAMPAGNOLO IBERICA S.L.  
Avda. de Los Huetos 46. pab, 3-2ª  
fila  
01010 VITORIA  
Tel. +34-945-217195  
Fax: +34-945-217198  
E-mail: campagnolo@campagnolo.es

**TAIWAN**

PRIMATEK LTD  
No. 4, Gongyequ 10th Rd., Nantue  
Dist.,  
TAICHUNG CITY 408 - TAIWAN  
(R.O.C.)  
Tel. +886-4-23506831  
Fax: +886-4-23596764

**UNITED STATES**

CAMPAGNOLO NORTH AMERICA  
INC.  
5431 Avenida Encinas, Suite C -  
CARLSBAD CA 92008 - U.S.A.  
Tel. +1-760-9310106  
Fax: +1-760-9310991  
E-mail: info@campagnolona.com

**BENELUX**

INTERNATIONAL  
CYCLE CONNECTION I.C.C.  
Communicatielaan 5A  
4538 BV TERNEUZEN  
NEDERLANDS  
Tel. + 31 (0)115 649321  
Fax: + 31 (0)115 649110  
E-mail: info@i-c-c.nl  
Web: www.i-c-c.nl